

Specification for:

0P44130UC

110 Delta Drive
Pittsburgh, PA 15238
Phone: 412/696-1333
Fax: 412/696-0333
Email: magnetics@spang.com

DIMENSIONS

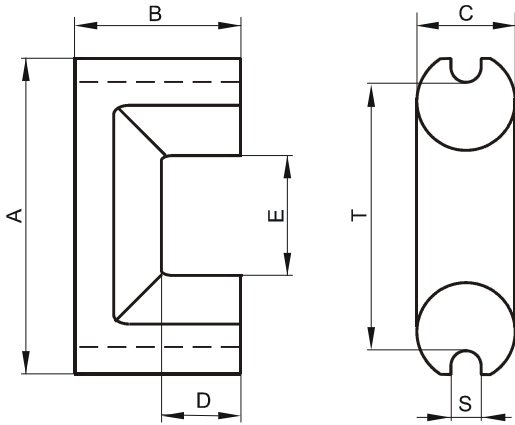

(mm)	Nominal:	Tol. min.:	Tol. max.:
A	41.78	-0.81	+ 0.81
B	30.5	-0.3	+ 0.3
C	11.94	-0.25	+ 0.25
D	20.8 Min.		
E	18.8	-0.56	+ 0.56
S	3.18	-0.13	+ 0.13
T	34.66		
Eff. Parameters			
Ae mm ²	Amin mm ²	le mm	Ve mm ³
112.1	105.4	154.8	17346

INDUCTANCE

AL value (nH)	Test conditions
Nom: 1520 Min.: 1140	10 kHz, < 0.5 mT, 25 °C

MARKING

P UC

CORE LOSSES

P _i max	Test conditions
140 mW/cm ³ (2.4 W/set)	100 kHz, 100 mT, 100 °C

NOTE

Spec. modifications	Previous	Revised
2005-06-22	A=42.37 Max. A=41.55 Min. B=30.78 Max. C=11.94 Max. E=18.42 Min. T=35.3 Ref. Losses: General P material	A=42.59 Max. A=40.97 Min. B=30.8 Max. C=12.19 Max. E=18.24 Min. T=34.66 Ref. Losses: Detail as indicated