

DIMENSIONS

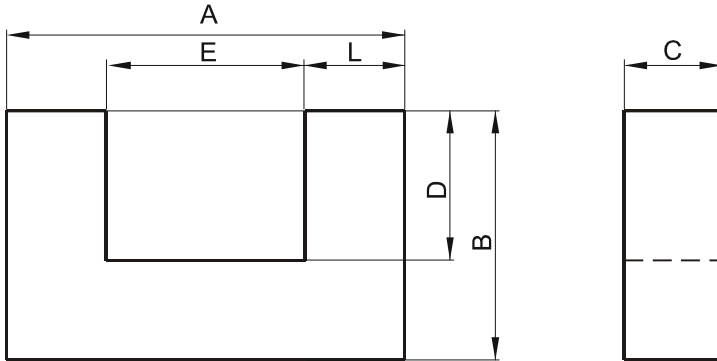

(mm)	Nominal:	Tol. min.:	Tol. max.:
A	22.1	-0.38	+ 0.38
B	20.6	-0.38	+ 0.38
C	6.27	-0.18	+ 0.18
D	13.98 Min.		
E	9.5	-0.38	+ 0.38
L	6.27	-0.18	+ 0.18
Eff. Parameters			
Ae mm²	Amin mm²	le mm	Ve mm³
39.7	39.7	95.8	4130

INDUCTANCE

AL value (nH/T ²)	Test conditions
Nom: 973 Min.: 730	10 kHz, < 0.5 mT, 25 °C

MARKING

P UC

CORE LOSSES

P _i max	Test conditions
< 0.43 W/set (< 104 mW/cm ³)	100 kHz, 100 mT, 100 °C

NOTE

Spec. modifications	Previous	Revised
2005-06-22	A=22.45 Max. B=20.96 Max. E=9.14 Min. Losses: General P material	A=22.48 Max. B=20.98 Max. E=9.12 Min. Losses: Detail as indicated