

Specification for:

**0P41515EC**

110 Delta Drive  
Pittsburgh, PA 15238  
Phone: 412/696-1333  
Fax: 412/696-0333  
Email: magnetics@spang.com

**DIMENSIONS**

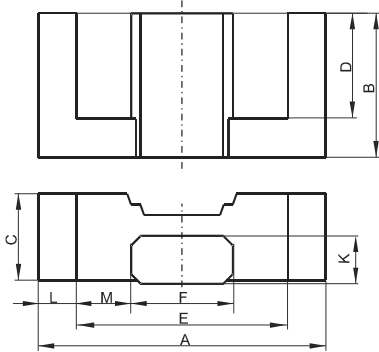

(mm)	Nominal:	Tol. min.:	Tol. max.:
<b>A</b>	15.0	-0.4	+ 0.4
<b>B</b>	7.5	-0.15	+ 0.15
<b>C</b>	4.65	-0.15	+ 0.15
<b>D</b>	5.5	-0.25	+ 0.25
<b>E</b>	11.0	-0.35	+ 0.35
<b>F</b>	5.3	-0.15	+ 0.15
<b>K</b>	2.4	-0.1	+ 0.1
<b>L</b>	2.0 Nom.		
<b>M</b>	2.85 Nom.		
<b>Eff. Parameters</b>			
<b>Ae mm<sup>2</sup></b>	<b>Amin mm<sup>2</sup></b>	<b>le mm</b>	<b>Ve mm<sup>3</sup></b>
15.0	12.2	34.0	510

**INDUCTANCE**

<b>AL value (nH)</b>	<b>Test conditions</b>
Nom: 973 Min.: 730	10 kHz, < 0.5 mT, 25 °C

**MARKING**

No marking
------------

**CORE LOSSES**

<b>P<sub>i</sub> max</b>	<b>Test conditions</b>
111 mW/cm <sup>3</sup> (0.057 W/set)	100 kHz, 100 mT, 100 °C

**NOTE**

<b>Spec. modifications</b>	<b>Previous</b>	<b>Revised</b>
2005-06-16	A=15.5±0.4 D=5.3 Min. Losses: General P material	A=15.0±0.4 D=5.25 Min. Losses: Detail as indicated