

DIMENSIONS

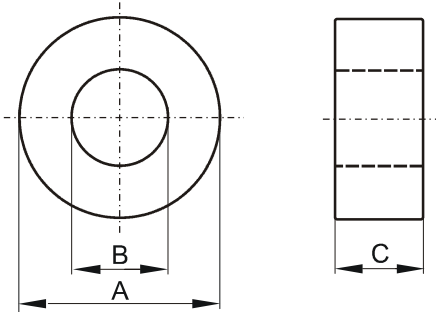

(mm)	Uncoated Nominal:	Min:	Max:
O.D. (A)	7.62	7.36	7.88
I.D. (B)	3.18	2.92	3.44
Ht. (C)	4.78	4.65	4.91
Eff. Parameters			
Ae mm²	le mm	Ve mm³	
9.96	15.0	149	

INDUCTANCE

AL value (nH/T ²)	Test conditions
2088 ± 25%	10 kHz, 0.5 mT (For N=5, use 0.28 mA), 25°C

CORE LOSSES

P _i max	Production lot limit Max avg	Test conditions
< 18.4 mW (< 123 mW/cm ³)	< 16.8 mW (< 112 mW/cm ³)	100 kHz, 100 mT, 100 °C

COATING

Uncoated

NOTE

Spec. modifications	Previous	Revised
2007-06-05	Losses: General P material	Losses: Detail as indicated