

DIMENSIONS

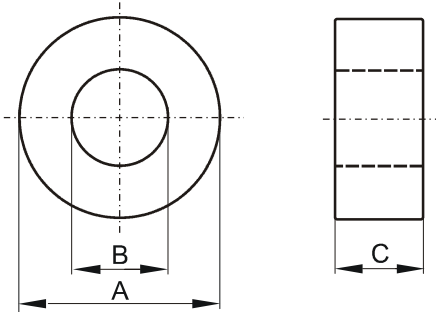

(mm)	Uncoated Nominal:	Min:	Max:
O.D. (A)	5.84	5.55	6.13
I.D. (B)	3.05	2.76	3.34
Ht. (C)	1.52	1.33	1.71
Eff. Parameters			
Ae mm²	le mm	Ve mm³	
2.00	13.0	26.7	

INDUCTANCE

AL value (nH/T ²)	Test conditions
488 ± 25%	10 kHz, 0.5 mT (For N=5, use 0.24 mA), 25°C

CORE LOSSES

P _i max	Production lot limit Max avg	Test conditions
< 3.30 mW (< 123 mW/cm ³)	< 3.00 mW (< 112 mW/cm ³)	100 kHz, 100 mT, 100 °C

COATING

Uncoated

NOTE

Spec. modifications	Previous	Revised
2007-06-05	Losses: General P material	Losses: Detail as indicated