

DIMENSIONS

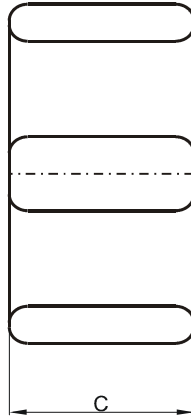
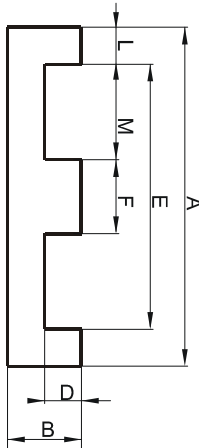

(mm)	Nominal:	Tol. min.:	Tol. max.:
A	14.0	-0.3	+ 0.3
B	2.5	-0.1	+ 0.1
C	5.0	-0.1	+ 0.1
D	1.0	-0.1	+ 0.1
E	11.0	-0.25	+ 0.25
F	3.0	-0.1	+ 0.1
L	1.5 Ref.		
M	4.0 Ref.		
Eff. Parameters			
Ae mm ²	Amin mm ²	le mm	Ve mm ³
14.7	14.7	16.7	244

INDUCTANCE

MARKING

AL value (nH/T ²)	Test conditions	No marking
780 ± 25%	10 kHz, < 0.5 mT, 25 °C	

CORE LOSSES

P _i max	Test conditions
< 0.054 W/set (< 221 mW/cm ³)	1000 kHz, 30 mT, 100 °C
< 0.097 W/set (< 398 mW/cm ³)	3000 kHz, 10 mT, 100 °C