

Specification for:

**0J49920UC**

110 Delta Drive  
Pittsburgh, PA 15238  
Phone: 412/696-1333  
Fax: 412/696-0333  
Email: magnetics@spang.com

**DIMENSIONS**

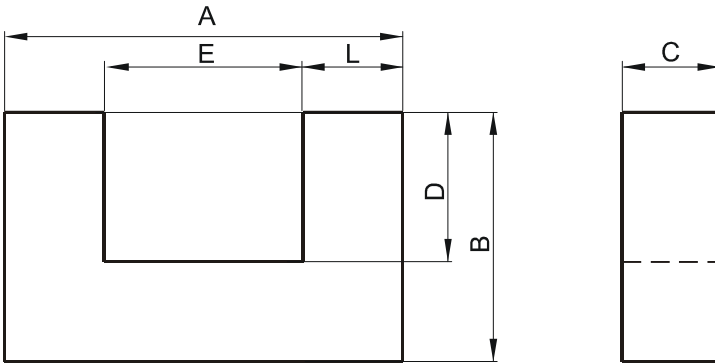

(mm)	Nominal:	Tol. min.:	Tol. max.:
<b>A</b>	126.0	-4.0	+ 4.0
<b>B</b>	91.0	-1.0	+ 1.0
<b>C</b>	20.0	-0.6	+ 0.6
<b>D</b>	63.0	-2.0	+ 2.0
<b>E</b>	70.0	-2.0	+ 2.0
<b>L</b>	28.0 Ref.		
<b>Eff. Parameters</b>			
<b>Ae mm<sup>2</sup></b>	<b>Amin mm<sup>2</sup></b>	<b>le mm</b>	<b>Ve mm<sup>3</sup></b>
560.0	560.0	480.0	268800

**INDUCTANCE**

<b>AL value (nH)</b>	<b>Test conditions</b>
Nom: 6967 Min.: 5226	10 kHz, < 0.5 mT, 25 °C

**MARKING**

No marking
------------

**LOSS FACTOR**

<b><math>\tan \delta/\mu</math> (<math>\times 10^{-6}</math>)</b>	<b>Test conditions</b>
< 100	100 kHz, < 0.25 mT, 25 °C