

Specification for:

**0J49316UC**

110 Delta Drive  
Pittsburgh, PA 15238  
Phone: 412/696-1333  
Fax: 412/696-0333  
Email: magnetics@spang.com

**DIMENSIONS**

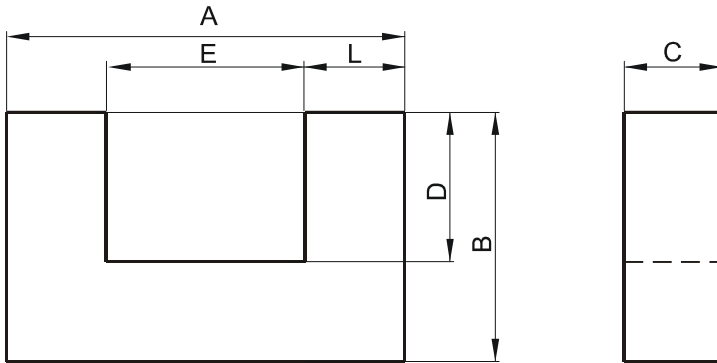

(mm)	Nominal:	Tol. min.:	Tol. max.:
<b>A</b>	93.0	-1.8	+ 1.8
<b>B</b>	76.0	-0.5	+ 0.5
<b>C</b>	16.0	-0.6	+ 0.6
<b>D</b>	48.0	-0.9	+ 0.9
<b>E</b>	36.2	-1.2	+ 1.2
<b>L</b>	28.4 Ref.		
<b>Eff. Parameters</b>			
<b>Ae mm<sup>2</sup></b>	<b>Amin mm<sup>2</sup></b>	<b>le mm</b>	<b>Ve mm<sup>3</sup></b>
447.0	447.0	258.0	115000

**INDUCTANCE**

<b>AL value (nH)</b>	<b>Test conditions</b>
Nom: 9924 Min.: 7443	10 kHz, < 0.5 mT, 25 °C

**MARKING**

No marking
------------

**LOSS FACTOR**

<b>tan <math>\delta/\mu</math> (<math>\times 10^{-6}</math>)</b>	<b>Test conditions</b>
< 100	100 kHz, < 0.25 mT, 25 °C