



Specification for:

**0J46113TC**

110 Delta Drive  
 Pittsburgh, PA 15238  
 Phone: 412/696-1333  
 Fax: 412/696-0333  
 Email: magnetics@spang.com

**DIMENSIONS**

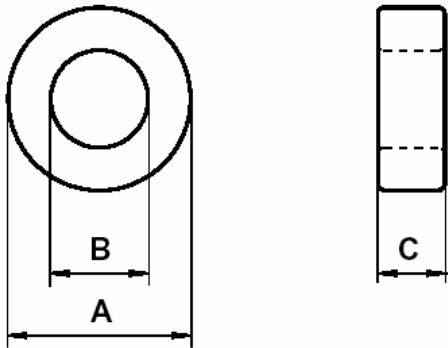

(mm)	Uncoated Nominal:	Min:	Max:
O.D. (A)	61.0	60.15	61.85
I.D. (B)	35.6	34.67	36.53
Ht. (C)	12.7	12.44	12.96

Eff. Parameters		
$A_e$ mm <sup>2</sup>	$l_e$ mm	$V_e$ mm <sup>3</sup>
157.4	144.6	22774

**INDUCTANCE**

$A_L$ value (nH/T <sup>2</sup> )	Test conditions	
6845 ± 20%	10 kHz	0.5 mT (For N = 1, use 6.8 mA), 25°C
> 5134	150 kHz	

**ELECTRICAL LOSSES**

$\tan \delta / \mu_i$	Test conditions
≤ 20 · 10 <sup>-6</sup>	100 kHz, 0.5 mT, 25°C

**COATING**

Uncoated
----------

**NOTE**

Spec. Modifications	Previous	Revised
2006.01.14	LF: General J Material	LF & Freq Response: Detail as indicated