



Specification for:

0J44925TC

110 Delta Drive
 Pittsburgh, PA 15238
 Phone: 412/696-1333
 Fax: 412/696-0333
 Email: magnetics@spang.com

DIMENSIONS

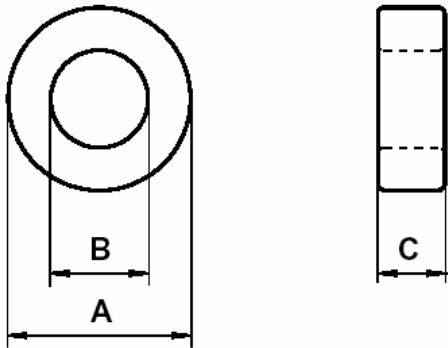

(mm)	Uncoated Nominal:	Min:	Max:
O.D. (A)	49.1	48.36	49.84
I.D. (B)	31.8	31.03	32.57
Ht. (C)	19.05	18.66	19.44

Eff. Parameters		
A_e mm ²	l_e mm	V_e mm ³
162	123	19927

INDUCTANCE

A_L value (nH/T ²)	Test conditions	
7435 ± 20%	10 kHz	0.5 mT (For N = 1, use 6.4 mA), 25°C
≥ 0.9 x A_L @ 10 kHz	200 kHz	

ELECTRICAL LOSSES

$\tan \delta / \mu_i$	Test conditions
≤ 20 · 10 ⁻⁶	100 kHz, 0.5 mT, 25°C

COATING

Uncoated

NOTE

Spec. Modifications	Previous	Revised
2006.01.14	LF: General J Material A_L value up to 200 kHz Large radius (4.3 mm) on top and bottom	LF: Detail as indicated A_L at 200 kHz ≥ 0.9 x A_L at 10 kHz Conventional toroid shape, with flats on top and bottom