

**DIMENSIONS**

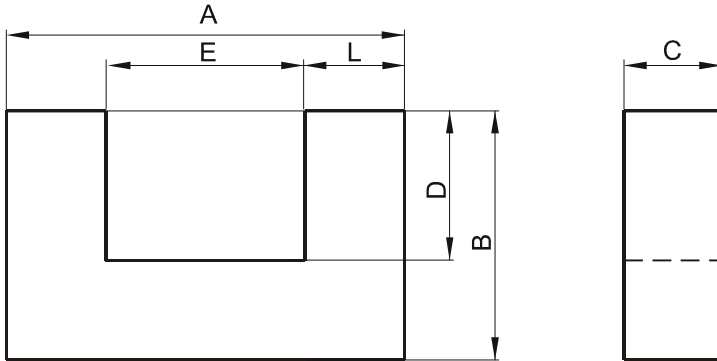

(mm)	Nominal:	Tol. min.:	Tol. max.:
<b>A</b>	25.4	-0.51	+ 0.51
<b>B</b>	15.9 Ref.		
<b>C</b>	12.7	-0.25	+ 0.25
<b>D</b>	9.27 Min.		
<b>E</b>	12.7 Ref.		
<b>L</b>	6.45	-0.15	+ 0.15
Eff. Parameters			
Ae mm <sup>2</sup>	Amin mm <sup>2</sup>	le mm	Ve mm <sup>3</sup>
80.8	80.8	83.4	6740

**INDUCTANCE**

**MARKING**

AL value (nH/T <sup>2</sup> )	Test conditions	No marking
Nom: 4860 Min.: 3650	10 kHz, < 0.5 mT, 25 °C	

**LOSS FACTOR**

$\tan \delta/\mu$	Test conditions
< 20 · 10 <sup>-6</sup>	100 kHz, < 0.25 mT, 25 °C

**NOTE**

Spec. modifications	Previous	Revised
2005-06-22	L=6.35±0.13 Loss factor: General J material	L=6.45±0.15 Loss factor: Detail as indicated