



Specification for:

# 0J42512UC

110 Delta Drive  
 Pittsburgh, PA 15238  
 Phone: 412/696-1333  
 Fax: 412/696-0333  
 Email: magnetics@spang.com

## DIMENSIONS

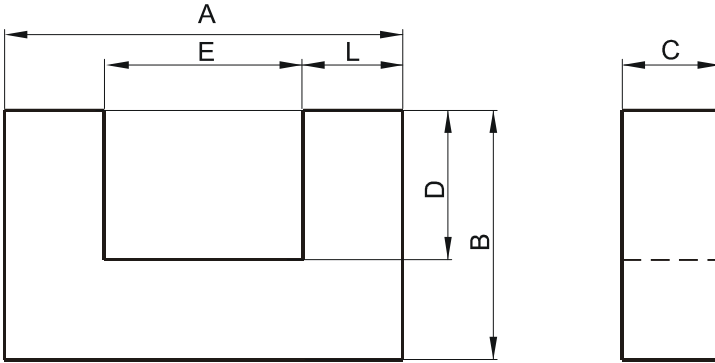

(mm)	Nominal:	Tol. min.:	Tol. max.:
<b>A</b>	25.4	-0.5	+ 0.5
<b>B</b>	12.9	-0.4	+ 0.4
<b>C</b>	12.7	-0.4	+ 0.4
<b>D</b>	6.35 Min.		
<b>E</b>	12.8 Ref.		
<b>L</b>	6.3	-0.13	+ 0.13
Eff. Parameters			
Ae mm <sup>2</sup>	Amin mm <sup>2</sup>	le mm	Ve mm <sup>3</sup>
80.0	80.0	68.9	4170

## INDUCTANCE

AL value (nH)	Test conditions
Nom: 4400 Min.: 3300	10 kHz, < 0.5 mT, 25 °C

## MARKING

No marking

## LOSS FACTOR

$\tan \delta/\mu$ ( $\times 10^{-6}$ )	Test conditions
< 20	100 kHz, < 0.25 mT, 25 °C

## NOTE

Spec. modifications	Previous	Revised
2005-06-22	B=12.57 Min. C=12.32 Min. C=13.08 Max. Loss factor: General J material	B=12.5 Min. C=12.3 Min. C=13.1 Max. Loss factor: Detail as indicated