

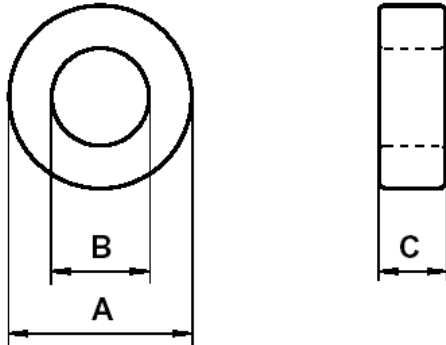

Specification for:  
**0J42109TC**

110 Delta Drive  
Pittsburgh, PA 15238  
Phone: 412/696-1333  
Fax: 412/696-0333  
Email:magnetics@spang.com

**DIMENSIONS**



(mm)	Uncoated Nominal:	Min:	Max:
O.D. (A)	20.6	20.24	20.96
I.D. (B)	12.7	12.31	13.09
Ht. (C)	8.89	8.63	9.15

Eff. Parameters		
A <sub>e</sub> mm <sup>2</sup>	l <sub>e</sub> mm	V <sub>e</sub> mm <sup>3</sup>
34	50	1733

**INDUCTANCE**

A <sub>L</sub> value (nH/T <sup>2</sup> )	Test conditions	
4200 ± 20%	10 kHz	0.5 mT (For N = 1, use 2.4 mA), 25°C
≥ 0.9 x A <sub>L</sub> @ 10 kHz	200 kHz	

**ELECTRICAL LOSSES**

tan δ / μ <sub>i</sub>	Test conditions
≤ 12·10 <sup>-6</sup>	100 kHz, 0.5 mT, 25°C

**COATING**

Uncoated
----------

**NOTE**

Spec. Modifications	Previous	Revised
2005.12.05	LF: General J Material	LF: Detail as indicated
	A <sub>L</sub> value up to 200 kHz	A <sub>L</sub> at 200 kHz ≥ 0.9 x A <sub>L</sub> at 10 kHz