

DIMENSIONS

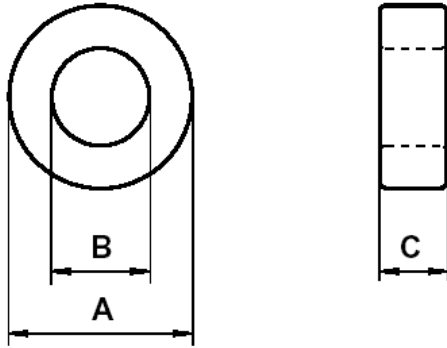

(mm)	Uncoated Nominal:	Min:	Max:
O.D. (A)	12.7	12.44	12.96
I.D. (B)	7.14	6.88	7.4
Ht. (C)	5.08	4.88	5.26

Eff. Parameters		
A_e mm ²	l_e mm	V_e mm ³
13.7	29.5	405.4

INDUCTANCE

A_L value (nH/T ²)	Test conditions	
2890 ± 20%	10 kHz	0.5 mT (For N = 1, use 1.4 mA), 25°C
≥ 0.9 x A_L @ 10 kHz	200 kHz	

ELECTRICAL LOSSES

$\tan \delta / \mu_i$	Test conditions
≤ 12·10 ⁻⁶	100 kHz, 0.5 mT , 25°C

COATING

Uncoated

NOTE

Spec. Modifications	Previous	Revised
2006.11.28	LF: General J Material	LF: Detail as indicated
	A_L value up to 200 kHz	A_L at 200 kHz ≥ 0.9 x A_L at 10 kHz