



Specification for:

**0J41106UC**

110 Delta Drive  
 Pittsburgh, PA 15238  
 Phone: 412/696-1333  
 Fax: 412/696-0333  
 Email:magnetics@spang.com

**DIMENSIONS**

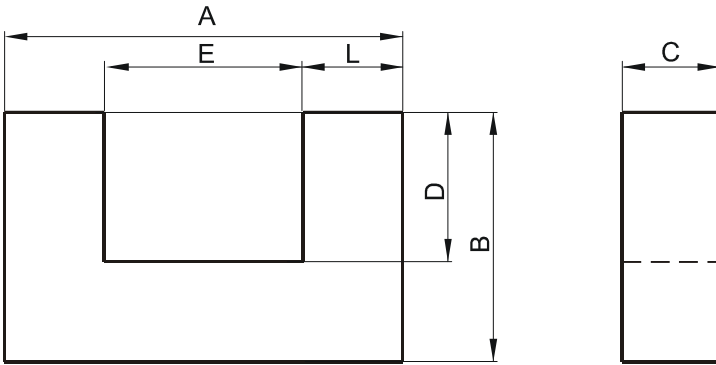

(mm)	Nominal:	Tol. min.:	Tol. max.:
<b>A</b>	10.85	-0.2	+ 0.2
<b>B</b>	4.19	-0.13	+ 0.13
<b>C</b>	6.3	-0.13	+ 0.13
<b>D</b>	2.24	-0.13	+ 0.13
<b>E</b>	7.19	-0.2	+ 0.2
<b>L</b>	1.83	-0.13	+ 0.13
Eff. Parameters			
Ae mm <sup>2</sup>	Amin mm <sup>2</sup>	le mm	Ve mm <sup>3</sup>
12.0	11.5	29.2	350

**INDUCTANCE**

AL value (nH)	Test conditions
Nom: 1773 Min.: 1330	10 kHz, < 0.5 mT, 25 °C

**MARKING**

No marking

**LOSS FACTOR**

tan δ/μ (x10 <sup>-6</sup> )	Test conditions
< 15	100 kHz, < 0.25 mT, 25 °C

**NOTE**

Spec. modifications	Previous	Revised
2005-06-22	A=10.8±0.2 Loss factor: General J material	A=10.85±0.2 Loss factor: Detail as indicated