

Specification for:

**0F45716UC**

110 Delta Drive  
Pittsburgh, PA 15238  
Phone: 412/696-1333  
Fax: 412/696-0333  
Email: magnetics@spang.com

**DIMENSIONS**

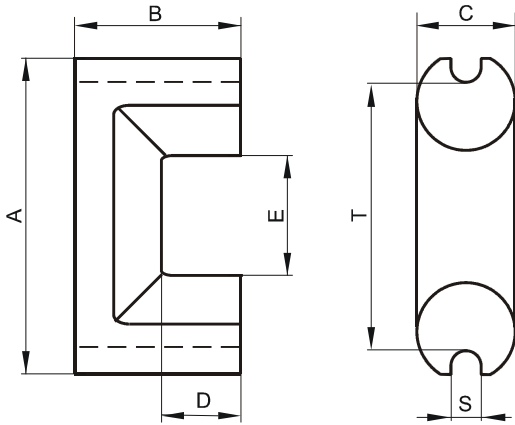

(mm)	Nominal:	Tol. min.:	Tol. max.:
<b>A</b>	57.65	-1.7	+ 1.7
<b>B</b>	28.6	-0.4	0.0
<b>C</b>	15.9	-0.4	+ 0.4
<b>D</b>	15.5	0.0	+ 1.0
<b>E</b>	27.8	-0.9	+ 0.9
<b>S</b>	4.8	-0.2	+ 0.2
<b>T</b>	49.8	-0.8	+ 0.8
<b>Eff. Parameters</b>			
<b>Ae mm<sup>2</sup></b>	<b>Amin mm<sup>2</sup></b>	<b>le mm</b>	<b>Ve mm<sup>3</sup></b>
171.0	171.0	163.0	27900

**INDUCTANCE**

AL value (nH)	Test conditions
3622 ± 25%	10 kHz, < 0.5 mT, 25 °C

**MARKING**

F UC
---------

**CORE LOSSES**

P <sub>i</sub> max	Test conditions
219 mW/cm <sup>3</sup> (6.1 W/set)	25 kHz, 200 mT, 100 °C