

Specification for:

0F44308EC

110 Delta Drive
Pittsburgh, PA 15238
Phone: 412/696-1333
Fax: 412/696-0333
Email:magnetics@spang.com

DIMENSIONS

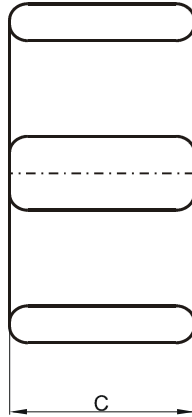
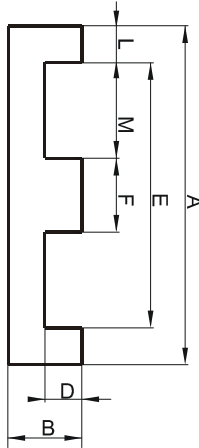

(mm)	Nominal:	Tol. min.:	Tol. max.:
A	43.2	-0.9	+ 0.9
B	8.51	-0.25	+ 0.25
C	27.9	-0.6	+ 0.6
D	4.19 MIN.		
E	34.7 MIN		
F	8.1	-0.2	+ 0.2
L	4.7 MAX		
M	13.2 MIN		
Eff. Parameters			
Ae mm ²	Amin mm ²	le mm	Ve mm ³
227	227	57.5	13100

INDUCTANCE

AL value (nH)	Test conditions
11172 ± 25%	10 kHz, < 0.5 mT, 25 °C

MARKING

No marking

CORE LOSSES

P _i max	Test conditions
206 mW/cm ³ (2.7 W/set)	25 kHz, 200 mT, 100 °C

NOTE

Spec. modifications	Previous	Revised
2005-06-01	Flat tooling resulting in sharp corners A=43.7 MAX. A=42.7 MIN. C=28.3 MAX. C=27.6 MIN. F=8.26 MAX. F=8.0 MIN, L=4.06±0.13 LOSSES:GENERAL F MATERIAL	Multilevel tooling resulting in radius corners A=44.1 MAX. A=42.3 MIN. C=28.5 MAX. C=27.3 MIN. F=8.3 MAX. F=7.9 MIN, L=4.7 MAX. LOSSES: DETAIL AS INDICATED