

Specification for:

**0F44125UC**

110 Delta Drive  
Pittsburgh, PA 15238  
Phone: 412/696-1333  
Fax: 412/696-0333  
Email: magnetics@spang.com

**DIMENSIONS**

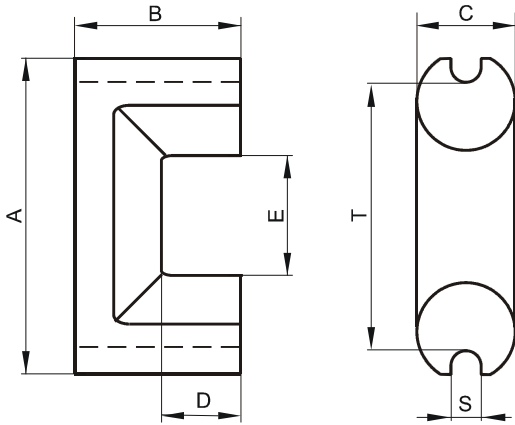

(mm)	Nominal:	Tol. min.:	Tol. max.:
<b>A</b>	41.78	-0.81	+ 0.81
<b>B</b>	25.4	-0.13	+ 0.13
<b>C</b>	11.94	-0.25	+ 0.25
<b>D</b>	15.9	-0.2	+ 0.2
<b>E</b>	18.8	-0.56	+ 0.56
<b>S</b>	3.18	-0.13	+ 0.13
<b>T</b>	34.66 Nom.		
Eff. Parameters			
Ae mm <sup>2</sup>	Amin mm <sup>2</sup>	le mm	Ve mm <sup>3</sup>
113.1	105.4	134.4	15196

**INDUCTANCE**

AL value (nH)	Test conditions
2105 ± 25%	10 kHz, < 0.5 mT, 25 °C

**MARKING**

F UC
---------

**CORE LOSSES**

P <sub>i</sub> max	Test conditions
211 mW/cm <sup>3</sup> (3.2 W/set)	25 kHz, 200 mT, 100 °C

**NOTE**

Spec. modifications	Previous	Revised
2005-06-22	A=42.37 Max. A=41.55 Min. C=11.94 Max. E=18.42 Min. T=35.3 Ref. Losses: General F material	A=42.59 Max. A=40.97 Min. C=12.19 Max. E=18.24 Min. T=34.66 Ref. Losses: Detail as indicated