

Specification for:

**0F44008EC**

110 Delta Drive  
Pittsburgh, PA 15238  
Phone: 412/696-1333  
Fax: 412/696-0333  
Email: magnetics@spang.com

**DIMENSIONS**

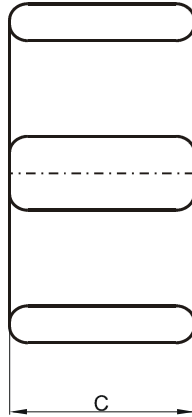
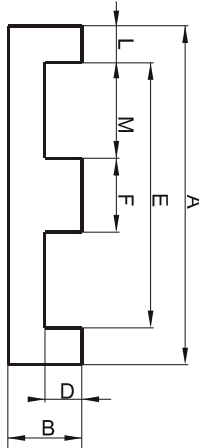

(mm)	Nominal:	Tol. min.:	Tol. max.:
<b>A</b>	40.65	-0.5	+ 0.5
<b>B</b>	8.51	-0.25	+ 0.25
<b>C</b>	10.7	-0.25	+ 0.25
<b>D</b>	4.06	-0.25	+ 0.25
<b>E</b>	30.45	-0.3	+ 0.3
<b>F</b>	10.15	-0.15	+ 0.15
<b>L</b>	5.1 Ref.		
<b>M</b>	10.15 Ref.		
Eff. Parameters			
Ae mm <sup>2</sup>	Amin mm <sup>2</sup>	le mm	Ve mm <sup>3</sup>
101	95.1	51.9	5220

**INDUCTANCE**

AL value (nH)	Test conditions
5134 ± 25%	10 kHz, < 0.5 mT, 25 °C

**MARKING**

F EC
---------

**CORE LOSSES**

P <sub>i</sub> max	Test conditions
211 mW/cm <sup>3</sup> (1.1 W/set)	25 kHz, 200 mT, 100 °C

**NOTE**

Spec. modifications	Previous	Revised
2005-06-22	AL=5488±25% L=5.08±0.13 Losses: General F material	AL=5134±25% L=5.1 Ref. Losses: Detail as indicated