



Specification for:

0F42512UC

110 Delta Drive
 Pittsburgh, PA 15238
 Phone: 412/696-1333
 Fax: 412/696-0333
 Email:magnetics@spang.com

DIMENSIONS

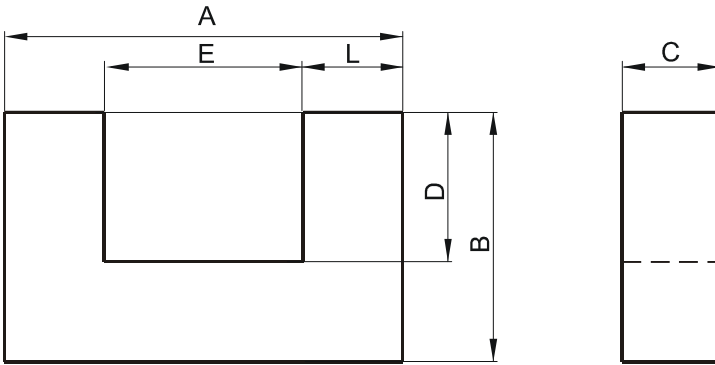

(mm)	Nominal:	Tol. min.:	Tol. max.:
A	25.4	-0.5	+ 0.5
B	12.9	-0.4	+ 0.4
C	12.7	-0.4	+ 0.4
D	6.35 Min.		
E	12.8 Ref.		
L	6.3	-0.13	+ 0.13
Eff. Parameters			
Ae mm²	Amin mm²	le mm	Ve mm³
80.0	80.0	68.9	4170

INDUCTANCE

AL value (nH)	Test conditions
2480 ± 25%	10 kHz, < 0.5 mT, 25 °C

MARKING

F UC

CORE LOSSES

P _i max	Test conditions
230 mW/cm ³ (0.96 W/set)	25 kHz, 200 mT, 100 °C

NOTE

Spec. modifications	Previous	Revised
2005-06-22	B=12.57 Min. C=12.32 Min. C=13.08 Max. Losses: General F material	B=12.5 Min. C=12.3 Min. C=13.1 Max. Losses: Detail as indicated