

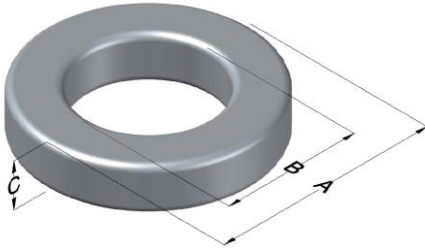

0079913A7

110 Delta Drive
 Pittsburgh, PA 15238
 NAFTA Sales: (1)800-245-3984
 HK Sales : (852)3102-9337
 magnetics@spang.com
 www.mag-inc.com



Kool M μ MAX Permeability (μ)	A _L (nH/T ²)	Core Marking			Coating Color
		Lot Number	Part Number	Inductance Grade	
19	27 \pm 8%	XXXXXX	79913A7	N/A	Black

Dimensions	Uncoated		Coated Limits			Packaging Cardboard cut-outs Box Qty= 40 pcs
	(mm)	(in)	(mm)	(in)		
OD (A)	77.80	3.063	78.95	3.108	max	
ID (B)	49.20	1.938	48.20	1.898	min	
HT (C)	15.9	0.625	17.1	0.670	max	

Electrical Characteristics			Physical Characteristics						
Watt Loss @50 kHz, 100mT max (mW/cm ³)	DC Bias min (A-T/cm)		Voltage Breakdown wire to wire min (V _{AC})	Break Strength min (kg)	Window Area W _A (mm ²)	Cross Section A _e (mm ²)	Path Length L _e (mm)	Volume V _e (mm ³)	Weight (g)
	80%	50%							
325	185	375	2000	113	1,820	221	196	43,400	256

Winding Information					Temperature Rating	
Winding Length Per Turn				Wound Coil Dimensions (mm)		Curie Temp: 500°C
Winding Factor	(mm)	Winding Factor	(mm)	40% Winding Factor		Coating Temp (Continuous up to): 200°C
				OD	86.6	Notes:
0%	64.7	40%	89.9	HT	32.3	
				Max OD	112	
20%	77.2	45%	93.1	Max HT	57.7	
25%	80.5	50%	96.8	Surface Area (mm ²)		
30%	82.7	60%	104	Unwound Core	13,000	
35%	86.8	70%	113	40% Winding Factor	23,000	

