

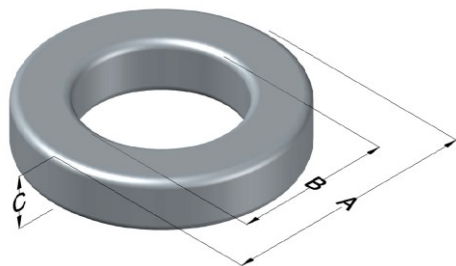

0079909A7

110 Delta Drive
 Pittsburgh, PA 15238
 NAFTA Sales: (1)800-245-3984
 HK Sales : (852)3102-9337
 magnetics@spang.com
 www.mag-inc.com



Kool M μ MAX Permeability (μ)	A_L (nH/T ²)	Core Marking			Coating Color
		Lot Number	Part Number	Inductance Grade	
14	20 \pm 8%	XXXXXX	79909A7	N/A	Black

Dimensions					Packaging
Uncoated		Coated Limits			
	(mm)	(in)	(mm)	(in)	
OD (A)	77.80	3.063	78.94	3.108	Cardboard cut-outs Box Qty = 40 Pcs
ID (B)	49.23	1.938	48.21	1.898	
HT (C)	15.88	0.625	17.02	0.670	

Electrical Characteristics			Physical Characteristics						
Watt Loss @ 50kHz, 100mT (nom, mW/cm ³)	DC Bias nom. (Oe)		Voltage Breakdown wire-to-wire min (V _{AC})	Break Strength (min, kg)	Window Area, W _A (mm ²)	Cross Section, A _e (mm ²)	Path Length, L _e (mm)	Volume V _e (mm ³)	Weight (g)
	80%	50%							
305	280	520	2000	140.6	1825	221	196	43400	273.4

Winding Information					Temperature Rating	
Winding Length per Turn			Wound Coil Dimensions (mm)		Curie Temp (°C):	
Winding Factor	(mm)	Winding Factor	(mm)	40% Winding Factor	OD	500 °C
0%	64.7	40%	89.9	Completely Full Window	86.6	Coating Temp: 200 °C (Continuous, up to; °C)
20%	77.2	45%	93.1		HT	
25%	80.5	50%	96.8	Surface Area (mm ²)	Max OD	Notes:
30%	82.7	60%	104.4		Max HT	
35%	86.8	70%	112.9	Unwound Core:	13000	
				40% Wound:	24000	

