

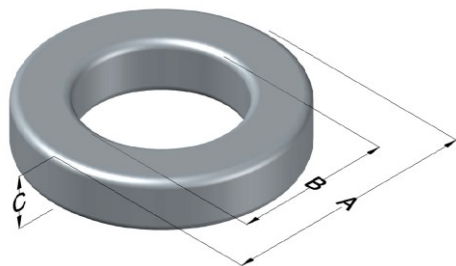

**0079869A7**

110 Delta Drive  
 Pittsburgh, PA 15238  
 NAFTA Sales: (1)800-245-3984  
 HK Sales : (852)3102-9337  
 magnetics@spang.com  
 www.mag-inc.com



Kool M $\mu$ MAX Permeability ( $\mu$ )	A <sub>L</sub> (nH/T <sup>2</sup> )	Core Marking			Coating Color
		Lot Number	Part Number	Inductance Grade	
14	16 $\pm$ 8%	XXXXXX	79869A7	N/A	Black

Dimensions					Packaging
Uncoated		Coated Limits			
	(mm)	(in)	(mm)	(in)	
OD (A)	77.80	3.063	78.94	3.108	Cardboard cut-outs Box Qty = 45 Pcs
ID (B)	49.23	1.938	48.21	1.898	
HT (C)	12.70	0.500	13.84	0.545	

Electrical Characteristics			Physical Characteristics						
Watt Loss @ 50kHz, 100mT (nom, mW/cm <sup>3</sup> )	DC Bias nom. (Oe)		Voltage Breakdown wire-to-wire min (V <sub>AC</sub> )	Break Strength (min, kg)	Window Area, W <sub>A</sub> (mm <sup>2</sup> )	Cross Section, A <sub>e</sub> (mm <sup>2</sup> )	Path Length, L <sub>e</sub> (mm)	Volume V <sub>e</sub> (mm <sup>3</sup> )	Weight (g)
	80%	50%							
305	280	520	2000	140.6	1825	176	196	34500	217.4

Winding Information					Temperature Rating	
Winding Length per Turn			Wound Coil Dimensions (mm)		Curie Temp (°C):	500 °C
Winding Factor	(mm)	Winding Factor	(mm)	40% Winding Factor	OD	86.6
0%	58.4	40%	83.5	Completely Full Window	HT	29.1
20%	70.9	45%	86.7		Max OD	112.0
25%	74.1	50%	90.4	Surface Area (mm <sup>2</sup> )	Max HT	54.3
30%	76.3	60%	98.1		Unwound Core:	11000
35%	80.4	70%	106.6		40% Wound:	23000

