

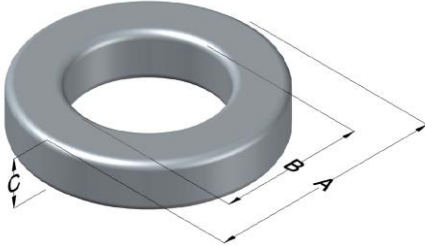

**0079776A7**

110 Delta Drive  
 Pittsburgh, PA 15238  
 NAFTA Sales: (1)800-245-3984  
 HK Sales : (852)3102-9337  
 magnetics@spang.com  
 www.mag-inc.com



Kool M $\mu$ MAX Permeability ( $\mu$ )	A <sub>L</sub> (nH/T <sup>2</sup> )	Core Marking			Coating Color
		Lot Number	Part Number	Inductance Grade	
40	135 $\pm$ 8%	XXXXXX	79776A7	N/A	Black

Dimensions	Uncoated		Coated Limits			Packaging
	(mm)	(in)	(mm)	(in)		
OD (A)	77.80	3.063	78.95	3.108	max	Cardboard cut-outs Box Qty= 20 pcs
ID (B)	39.34	1.549	38.34	1.509	min	
HT (C)	25.85	1.018	26.85	1.057	max	

Electrical Characteristics			Physical Characteristics						
Watt Loss @ 100 kHz, 100mT max (mW/cm <sup>3</sup> )	DC Bias min (oersteds)		Voltage Breakdown wire to wire min (V <sub>AC</sub> )	Break Strength min (kg)	Window Area W <sub>A</sub> (mm <sup>2</sup> )	Cross Section A <sub>e</sub> (mm <sup>2</sup> )	Path Length L <sub>e</sub> (mm)	Volume V <sub>e</sub> (mm <sup>3</sup> )	Weight (g)
	80%	50%							
700	83.0	180	2000	140.0	1,150	478	170	81,500	520

Winding Information					Temperature Rating	
Winding Length Per Turn				Wound Coil Dimensions (mm)		Curie Temp: 500°C
Winding Factor	(mm)	Winding Factor	(mm)	40% Winding Factor	OD	91.0
					HT	45.4
0%	94.3	40%	114	Completely Full Window	Max OD	117
20%	104	45%	117		Max HT	69.3
25%	107	50%	120	Surface Area (mm <sup>2</sup> )		
30%	109	60%	126	Unwound Core		19,000
35%	112	70%	132	40% Winding Factor		32,000
Notes:						
Coating Temp (Continuous up to): 200°C						

