

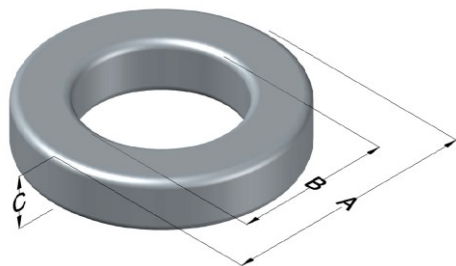

0079774A7

110 Delta Drive
 Pittsburgh, PA 15238
 NAFTA Sales: (1)800-245-3984
 HK Sales : (852)3102-9337
 magnetics@spang.com
 www.mag-inc.com



Kool Mu MAX Permeability (μ)	A_L (nH/T ²)	Core Marking			Coating Color
		Lot Number	Part Number	Inductance Grade	
14	47 \pm 8%	XXXXXX	79774A7	N/A	Black

Dimensions					Packaging
Uncoated		Coated Limits			
	(mm)	(in)	(mm)	(in)	
OD (A)	77.80	3.063	78.95	3.108	Cardboard cut-outs Box Qty = 20 Pcs
ID (B)	39.34	1.549	38.34	1.509	
HT (C)	25.85	1.018	26.85	1.057	

Electrical Characteristics			Physical Characteristics						
Watt Loss @ 50kHz, 100mT (nom, mW/cm ³)	DC Bias nom. (Oe)		Voltage Breakdown wire-to-wire min (V _{AC})	Break Strength (min, kg)	Window Area, W _A (mm ²)	Cross Section, A _e (mm ²)	Path Length, L _e (mm)	Volume V _e (mm ³)	Weight (g)
	80%	50%							
305	280	520	2000	140.6	1155	478	170	81500	513.5

Winding Information					Temperature Rating		
Winding Length per Turn			Wound Coil Dimensions (mm)		Curie Temp (°C):		
Winding Factor	(mm)	Winding Factor	(mm)	40% Winding Factor	OD	500 °C	
0%	94.3	40%	114.0	Completely Full Window	HT	Coating Temp: 200 °C (Continuous, up to; °C)	
20%	104.0	45%	117.0		Max OD		117.0
25%	107.0	50%	120.0	Surface Area (mm ²)	Max HT	Notes:	
30%	109.0	60%	126.0		Unwound Core:		19000
35%	112.0	70%	132.0		40% Wound:		32000

