

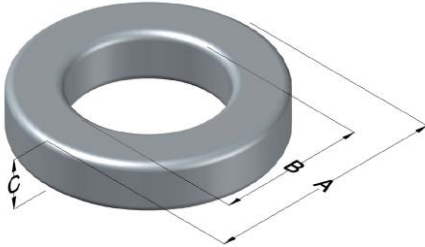

0079744A7

110 Delta Drive
 Pittsburgh, PA 15238
 NAFTA Sales: (1)800-245-3984
 HK Sales : (852)3102-9337
 magnetics@spang.com
 www.mag-inc.com



Kool M μ MAX Permeability (μ)	A _L (nH/T ²)	Core Marking			Coating Color
		Lot Number	Part Number	Inductance Grade	
19	64 ± 8%	XXXXXX	79744A7	N/A	Black

Dimensions	Uncoated		Coated Limits			Packaging
	(mm)	(in)	(mm)	(in)		
OD (A)	74.10	2.917	75.01	2.953	max	Cardboard cut-outs Box Qty= 24 pcs
ID (B)	45.30	1.783	44.39	1.748	min	
HT (C)	35.00	1.378	35.92	1.414	max	

Electrical Characteristics			Physical Characteristics						
Watt Loss @ 50 kHz, 100mT max (mW/cm ³)	DC Bias min (oersteds)		Voltage Breakdown wire to wire min (V _{AC})	Break Strength min (kg)	Window Area W _A (mm ²)	Cross Section A _e (mm ²)	Path Length L _e (mm)	Volume V _e (mm ³)	Weight (g)
	80%	50%							
325	185	375	2000	227.0	1,550	497	184	91,400	540

Winding Information					Temperature Rating	
Winding Length Per Turn				Wound Coil Dimensions (mm)		Curie Temp: 500°C
Winding Factor	(mm)	Winding Factor	(mm)	40% Winding Factor		Coating Temp (Continuous up to): 200°C
				OD	91.0	Notes:
				HT	55.2	
				Completely Full Window		
				Max OD	102	
				Max HT	65.7	
				Surface Area (mm ²)		
				Unwound Core		19,000
				40% Winding Factor		33,000
0%	102	40%	125			
20%	114	45%	129			
25%	117	50%	132			
30%	119	60%	139			
35%	122	70%	147			

