

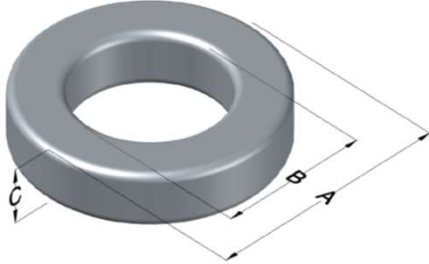

0079735A7X2

110 Delta Drive
 Pittsburgh, PA 15238
 NAFTA Sales: (1)800-245-3984
 HK Sales : (852)3102-9337
 magnetics@spang.com



Kool M μ MAX Permeability (μ)	A _L (nH/T ²)	Core Marking			Coating Color
		Lot Number	Part Number	Inductance Grade	
26	177 \pm 8%	XXXXXX	79735A7X2	N/A	Black

Dimensions	Uncoated		Coated Limits			Packaging
	(mm)	(in)	(mm)	(in)		
OD (A)	74.09	2.917	75.51	2.973	max	Cardboard cut-outs Box Qty = TBD
ID (B)	45.29	1.783	43.80	1.724	min	
HT (C)	70.00	2.756	71.42	2.812	max	

Electrical Characteristics			Physical Characteristics						
Watt Loss @ 100kHz, 100mT max (mW/cm ³)	DC Bias min (oersteds)		Voltage Breakdown wire to wire min (V _{AC})	Break Strength min (kg)	Window Area W _a (mm ²)	Cross Section A _e (mm ²)	Path Length L _e (mm)	Volume V _e (mm ³)	Est. Weight (g)
	700	80%							
	135	285	3000	227.0	1,550	995	184	183,000	1,210

Winding Information					Temperature Rating	
Winding Length Per Turn				Wound Coil Dimensions (mm)		Curie Temp: 500°C
Winding Factor	(mm)	Winding Factor	(mm)	40% Winding Factor		Coating Temp (Continuous up to): 200°C
				OD	84.3	
				HT	84.6	Notes:
0%	175	40%	197	Max OD	88.7	
20%	186	45%	200	Max HT	102	
25%	188	50%	203	Surface Area (mm ²)		
30%	191	60%	210	Unwound Core		33,000
35%	194	70%	218	40% Winding Factor		40,000

