

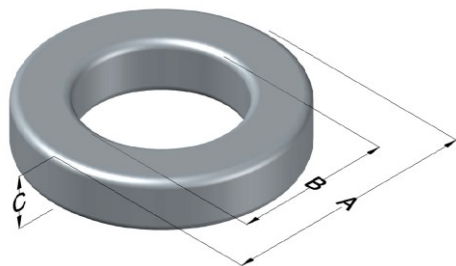

0079734A7

110 Delta Drive
 Pittsburgh, PA 15238
 NAFTA Sales: (1)800-245-3984
 HK Sales : (852)3102-9337
 magnetics@spang.com
 www.mag-inc.com



Kool Mu MAX Permeability (μ)	A_L (nH/T ²)	Core Marking			Coating Color
		Lot Number	Part Number	Inductance Grade	
14	48 ± 8%	XXXXXX	79734A7	N/A	Black

Dimensions					Packaging
Uncoated		Coated Limits			
	(mm)	(in)	(mm)	(in)	
OD (A)	74.09	2.917	75.01	2.953	Cardboard cut-outs Box Qty = 24 Pcs
ID (B)	45.29	1.783	44.40	1.748	
HT (C)	35.00	1.378	35.92	1.414	

Electrical Characteristics			Physical Characteristics						
Watt Loss @ 50kHz, 100mT (nom, mW/cm ³)	DC Bias nom. (Oe)		Voltage Breakdown wire-to-wire min (V _{AC})	Break Strength (min, kg)	Window Area, W _A (mm ²)	Cross Section, A _e (mm ²)	Path Length, L _e (mm)	Volume V _e (mm ³)	Weight (g)
	80%	50%							
305	280	520	2000	226.8	1548	497	184	91400	575.8

Winding Information				Temperature Rating		
Winding Length per Turn			Wound Coil Dimensions (mm)		Curie Temp (°C):	500 °C
Winding Factor	(mm)	Winding Factor	(mm)	40% Winding Factor		
0%	102.4	40%	125.4	Completely Full Window	OD	91.0
20%	113.9	45%	128.5		HT	55.2
25%	116.8	50%	132.0	Surface Area (mm ²)	Max OD	102.0
30%	118.9	60%	138.7		Unwound Core:	65.7
35%	122.5	70%	146.5	40% Wound:		19000
						33000

