

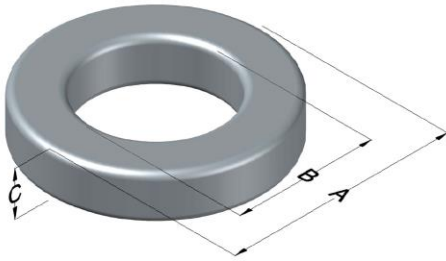

0079733A7

110 Delta Drive
 Pittsburgh, PA 15238
 NAFTA Sales: (1)800-245-3984
 HK Sales : (852)3102-9337
 magnetics@spang.com
 www.mag-inc.com



Kool M μ MAX Permeability (μ)	A _L (nH/T ²)	Core Marking			Coating Color
		Lot Number	Part Number	Inductance Grade	
40	117 ± 8%	XXXXXX	79733A7	N/A	Black

Dimensions	Uncoated		Coated Limits		Packaging
	(mm)	(in)	(mm)	(in)	
OD (A)	50.55	1.990	51.31	2.020	Cardboard cut-outs Box Qty= 70 pcs
ID (B)	24.89	0.980	23.88	0.940	
HT (C)	21.08	0.830	21.59	0.850	

Electrical Characteristics			Physical Characteristics						
Watt Loss @ 100 kHz, 100mT max(mW/cm ³)	DC Bias min (A-T/cm)		Voltage Breakdown wire to wire min (V _{AC})	Break Strength min (kg)	Window Area W _A (mm ²)	Cross Section A _e (mm ²)	Path Length L _e (mm)	Volume V _e (mm ³)	Weight (g)
	80%	50%							
700	65.9	143	2000	95	452	262	113.5	29,700	190

Winding Information					Temperature Rating	
Winding Length Per Turn				Wound Coil Dimensions (mm)		Curie Temp: 500°C
Winding Factor	(mm)	Winding Factor	(mm)	40% Winding Factor		Coating Temp (Continuous up to): 200°C
				OD	64.0	
				HT	39.6	Notes:
				Max OD	72.0	
				Max HT	42.0	
0%	131	40%	143	Surface Area (mm ²)		
20%	137	45%	145	Unwound Core		23,310
25%	138	50%	147	40% Winding Factor		33,600
30%	140	60%	150			
35%	142	70%	155			

