

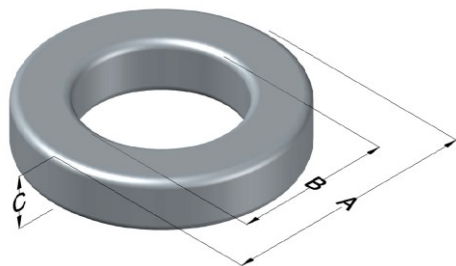

0079728A7

110 Delta Drive
 Pittsburgh, PA 15238
 NAFTA Sales: (1)800-245-3984
 HK Sales : (852)3102-9337
 magnetics@spang.com
 www.mag-inc.com



Kool M μ MAX Permeability (μ)	A_L (nH/T ²)	Core Marking			Coating Color
		Lot Number	Part Number	Inductance Grade	
14	41 \pm 8%	XXXXXX	79728A7	N/A	Black

Dimensions					Packaging
Uncoated		Coated Limits			
	(mm)	(in)	(mm)	(in)	
OD (A)	50.55	1.990	51.31	2.020	Cardboard cut-outs Box Qty = 70 Pcs
ID (B)	24.89	0.980	23.88	0.940	
HT (C)	21.08	0.830	21.59	0.850	

Electrical Characteristics			Physical Characteristics						
Watt Loss @ 50kHz, 100mT (nom, mW/cm ³)	DC Bias nom. (Oe)		Voltage Breakdown wire-to-wire min (V _{AC})	Break Strength (min, kg)	Window Area, W _A (mm ²)	Cross Section, A _e (mm ²)	Path Length, L _e (mm)	Volume V _e (mm ³)	Weight (g)
	80%	50%							
305	280	520	2000	95.2	448	262	113.5	29700	187.1

Winding Information				Temperature Rating	
Winding Length per Turn			Wound Coil Dimensions (mm)		Curie Temp (°C): 500 °C
Winding Factor	(mm)	Winding Factor	(mm)	40% Winding Factor	
0%	131.0	40%	143.0	OD	64.0
20%	137.0	45%	145.0	HT	39.6
25%	138.0	50%	147.0	Max OD	72.0
30%	140.0	60%	150.0	Max HT	42.0
35%	142.0	70%	155.0	Surface Area (mm ²)	
				Unwound Core:	23310
				40% Wound:	33600

