

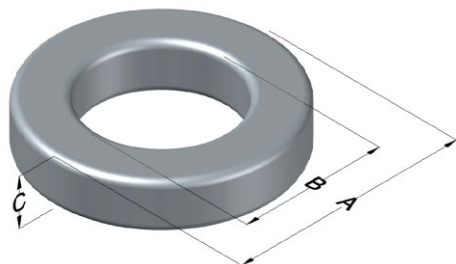

**0079718A7**

110 Delta Drive  
 Pittsburgh, PA 15238  
 NAFTA Sales: (1)800-245-3984  
 HK Sales : (852)3102-9337  
 magnetics@spang.com  
 www.mag-inc.com



Kool M $\mu$ MAX Permeability ( $\mu$ )	A <sub>L</sub> (nH/T <sup>2</sup> )	Core Marking			Coating Color
		Lot Number	Part Number	Inductance Grade	
14	17 ± 8%	XXXXXX	79718A7	N/A	Black

Dimensions					Packaging
Uncoated		Coated Limits			
	(mm)	(in)	(mm)	(in)	
OD (A)	50.80	2.000	51.69	2.035	Cardboard cut-outs Box Qty = 90 Pcs
ID (B)	31.75	1.250	30.94	1.218	
HT (C)	13.46	0.530	14.35	0.565	

Electrical Characteristics			Physical Characteristics						
Watt Loss @ 50kHz, 100mT (nom, mW/cm <sup>3</sup> )	DC Bias nom. (Oe)		Voltage Breakdown wire-to-wire min (V <sub>AC</sub> )	Break Strength (min, kg)	Window Area, W <sub>A</sub> (mm <sup>2</sup> )	Cross Section, A <sub>e</sub> (mm <sup>2</sup> )	Path Length, L <sub>e</sub> (mm)	Volume V <sub>e</sub> (mm <sup>3</sup> )	Weight (g)
	80%	50%							
305	280	520	2000	92.5	751	125	127	15900	100.2

Winding Information					Temperature Rating		
Winding Length per Turn			Wound Coil Dimensions (mm)		Curie Temp (°C):		
Winding Factor	(mm)	Winding Factor	(mm)	40% Winding Factor	OD	500 °C	
0%	49.5	40%	65.5	Completely Full Window	HT	Coating Temp: 200 °C (Continuous, up to; °C)	
20%	57.4	45%	67.7		Max OD		72.4
25%	59.6	50%	70.1	Surface Area (mm <sup>2</sup> )	Max HT	Notes:	
30%	61.0	60%	74.9		Unwound Core:		6400
35%	63.5	70%	80.3		40% Wound:		11000

