

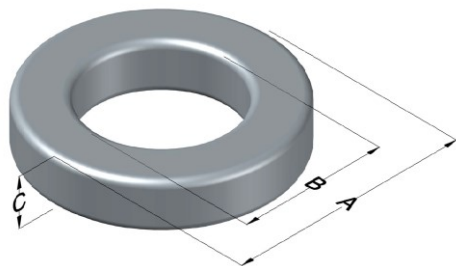

0079551A7

110 Delta Drive
 Pittsburgh, PA 15238
 NAFTA Sales: (1)800-245-3984
 HK Sales : (852)3102-9337
 magnetics@spang.com
 www.mag-inc.com



Kool M μ MAX Permeability (μ)	A_L (nH/T ²)	Core Marking			Coating Color
		Lot Number	Part Number	Inductance Grade	
14	14 \pm 8%	XXXXXX	79551A7	N/A	Black

Dimensions					Packaging
Uncoated		Coated Limits			
	(mm)	(in)	(mm)	(in)	
OD (A)	32.79	1.291	33.66	1.325	Cardboard cut-outs Box Qty = 250 Pcs
ID (B)	20.09	0.791	19.46	0.766	
HT (C)	10.67	0.420	11.43	0.450	

Electrical Characteristics			Physical Characteristics						
Watt Loss @ 50kHz, 100mT (nom, mW/cm ³)	DC Bias nom. (Oe)		Voltage Breakdown wire-to-wire min (V _{AC})	Break Strength (min, kg)	Window Area, W _A (mm ²)	Cross Section, A _e (mm ²)	Path Length, L _e (mm)	Volume V _e (mm ³)	Weight (g)
	80%	50%							
305	280	520	2000	78.9	296	65.6	81.4	5340	33.6

Winding Information					Temperature Rating	
Winding Length per Turn			Wound Coil Dimensions (mm)		Curie Temp (°C):	500 °C
Winding Factor	(mm)	Winding Factor	(mm)	40% Winding Factor	OD	36.8
0%	37.4	40%	47.2	Completely Full Window	HT	17.8
20%	42.4	45%	48.8		Max OD	46.7
25%	43.5	50%	50.1	Surface Area (mm ²)	Max HT	28.0
30%	44.7	60%	53.2		Unwound Core:	3100
35%	46.1	70%	56.7		40% Wound:	4900

