

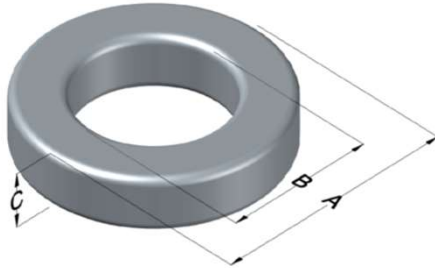

**0079451A7**

110 Delta Drive  
 Pittsburgh, PA 15238  
 NAFTA Sales: (1)800-245-3984  
 HK Sales : (852)3102-9337  
 magnetics@spang.com



Kool M $\mu$ MAX Permeability ( $\mu$ )	A <sub>L</sub> (nH/T <sup>2</sup> )	Core Marking			Coating Color
		Lot Number	Part Number	Inductance Grade	
60	108 ± 8%	XXXXXX	79451A7	N/A	Black

Dimensions	Uncoated		Coated Limits			Packaging
	(mm)	(in)	(mm)	(in)		
OD (A)	42.90	1.689	43.84	1.726	max	Cardboard cut-outs Box Qty = 120 Pcs
ID (B)	24.21	0.953	23.39	0.921	min	
HT (C)	16.26	0.640	17.27	0.680	max	

Electrical Characteristics			Physical Characteristics						
Watt Loss @ 100kHz, 100mT max (mW/cm <sup>3</sup> )	DC Bias min (oersteds)		Voltage Breakdown wire to wire min (V <sub>AC</sub> )	Break Strength min (kg)	Window Area W <sub>a</sub> (mm <sup>2</sup> )	Cross Section A <sub>e</sub> (mm <sup>2</sup> )	Path Length L <sub>e</sub> (mm)	Volume V <sub>e</sub> (mm <sup>3</sup> )	Est. Weight (g)
	80%	50%							
700	58	116	3000	98.8	430	148	103	15,100	121

Winding Information					Temperature Rating	
Winding Length Per Turn				Wound Coil Dimensions (mm)		Curie Temp: 500°C
Winding Factor	(mm)	Winding Factor	(mm)	40% Winding Factor		Coating Temp (Continuous up to): 200°C
				OD	48.6	
				HT	24.5	Notes:
				Completely Full Window		
				Max OD	51.0	
				Max HT	34.1	
0%	55.0	40%	66.8	Surface Area (mm <sup>2</sup> )		
20%	61.0	45%	68.6	Unwound Core		
25%	62.4	50%	70.2	5,800		
30%	63.6	60%	73.8	40% Winding Factor		
35%	65.5	70%	77.9	8,300		

