

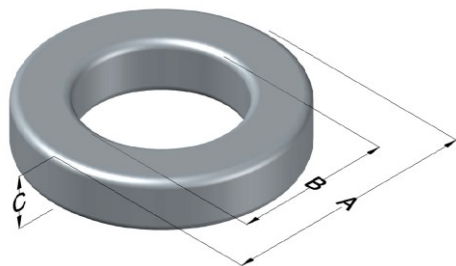

**0079450A7**

110 Delta Drive  
 Pittsburgh, PA 15238  
 NAFTA Sales: (1)800-245-3984  
 HK Sales : (852)3102-9337  
 magnetics@spang.com  
 www.mag-inc.com



Kool M $\mu$ MAX Permeability ( $\mu$ )	A <sub>L</sub> (nH/T <sup>2</sup> )	Core Marking			Coating Color
		Lot Number	Part Number	Inductance Grade	
40	72 $\pm$ 8%	XXXXXX	79450A7	N/A	Black

Dimensions					Packaging
Uncoated		Coated Limits			
	(mm)	(in)	(mm)	(in)	
OD (A)	42.90	1.689	43.83	1.724	Cardboard cut-outs Box Qty = 120 Pcs
ID (B)	24.20	0.953	23.40	0.921	
HT (C)	16.26	0.640	17.26	0.675	

Electrical Characteristics			Physical Characteristics						
Watt Loss @ 100kHz, 100mT (max, mW/cm <sup>3</sup> )	DC Bias min (Oersteds)		Voltage Breakdown wire-to-wire min (V <sub>AC</sub> )	Break Strength (min, kg)	Window Area, W <sub>A</sub> (mm <sup>2</sup> )	Cross Section, A <sub>e</sub> (mm <sup>2</sup> )	Path Length, L <sub>e</sub> (mm)	Volume V <sub>e</sub> (mm <sup>3</sup> )	Weight (g)
	80%	50%							
700	83	180	2000	98.8	430	147.5	102	15100	97.4

Winding Information					Temperature Rating	
Winding Length per Turn			Wound Coil Dimensions (mm)		Curie Temp (°C):	
Winding Factor	(mm)	Winding Factor	(mm)	40% Winding Factor	OD	500 °C
0%	55.0	40%	67.1	Completely Full Window	48.4	Coating Temp: (Continuous, up to; °C)
20%	61.1	45%	68.9		HT	
25%	62.5	50%	70.8	Surface Area (mm <sup>2</sup> )	Max OD	Notes:
30%	63.8	60%	74.2		Max HT	
35%	65.6	70%	78.5	Unwound Core:	5800	
				40% Wound:	8400	

