

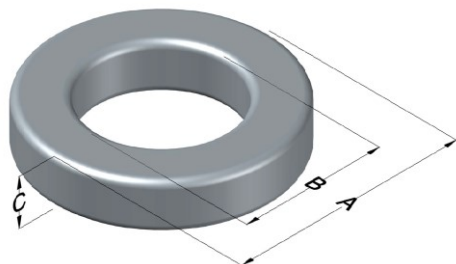

0079448A7

110 Delta Drive
 Pittsburgh, PA 15238
 NAFTA Sales: (1)800-245-3984
 HK Sales : (852)3102-9337
 magnetics@spang.com
 www.mag-inc.com



Kool M μ MAX Permeability (μ)	A _L (nH/T ²)	Core Marking			Coating Color
		Lot Number	Part Number	Inductance Grade	
26	47 ± 8%	XXXXXX	79448A7	N/A	Black

Dimensions					Packaging
Uncoated		Coated Limits			
	(mm)	(in)	(mm)	(in)	
OD (A)	42.90	1.689	43.83	1.724	max
ID (B)	24.20	0.953	23.40	0.921	min
HT (C)	16.26	0.640	17.26	0.675	max

Cardboard cut-outs
Box Qty = 120 Pcs

Electrical Characteristics			Physical Characteristics						
Watt Loss @ 100kHz, 100mT (max, mW/cm ³)	DC Bias min (Oersteds)		Voltage Breakdown wire-to-wire min (V _{AC})	Break Strength (min, kg)	Window Area, W _A (mm ²)	Cross Section, A _e (mm ²)	Path Length, L _e (mm)	Volume V _e (mm ³)	Weight (g)
	80%	50%							
700	133	285	2000	98.8	430	147.5	102	15100	95.8

Winding Information					Temperature Rating	
Winding Length per Turn			Wound Coil Dimensions (mm)		Curie Temp (°C):	500 °C
Winding Factor	(mm)	Winding Factor	(mm)	40% Winding Factor	OD	48.4
0%	55.0	40%	67.1	Completely Full Window	HT	21.8
20%	61.1	45%	68.9		Max OD	50.5
25%	62.5	50%	70.8	Surface Area (mm ²)	Max HT	23.9
30%	63.8	60%	74.2		Unwound Core:	5800
35%	65.6	70%	78.5		40% Wound:	8400

Coating Temp: (Continuous, up to; °C) 200 °C

Notes:

