

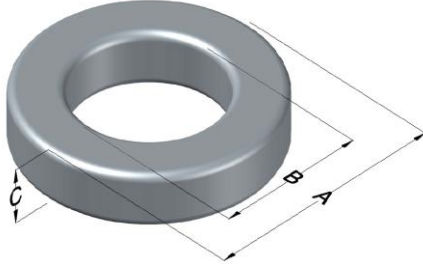

0079443A7HT20

110 Delta Drive
 Pittsburgh, PA 15238
 NAFTA Sales: (1)800-245-3984
 HK Sales : (852)3102-9337
 magnetics@spang.com



Kool M μ MAX Permeability (μ)	A _L (nH/T ²)	Core Marking			Coating Color
		Lot Number	Part Number	Inductance Grade	
75	185 ± 8%	XXXXXX	79443A7HT20	N/A	Black

Dimensions	Uncoated		Coated Limits			Packaging
	(mm)	(in)	(mm)	(in)		
OD (A)	46.74	1.840	47.63	1.875	max	Cardboard cut-outs Box Qty = TBD
ID (B)	24.13	0.950	23.32	0.918	min	
HT (C)	19.11	0.752	20.00	0.787	max	

Electrical Characteristics			Physical Characteristics						
Watt Loss @ 100 kHz, 100 mT max (mW/cm ³)	DC Bias min (oersteds)		Voltage Breakdown wire to wire min (V _{AC})	Break Strength min (kg)	Window Area W _a (mm ²)	Cross Section A _e (mm ²)	Path Length L _e (mm)	Volume V _e (mm ³)	Est. Weight (g)
	80%	50%							
700	40	85	3000	233	427	210.5	107.4	22,600	162

Winding Information					Temperature Rating	
Winding Length Per Turn				Wound Coil Dimensions (mm)		Curie Temp: 500°C
Winding Factor	(mm)	Winding Factor	(mm)	40% Winding Factor		Coating Temp (Continuous up to): 200°C
				OD	52.4	Notes:
0%	64.3	40%	76.3	HT	27.2	
				Max OD	54.8	
20%	70.4	45%	78.2	Max HT	36.8	
25%	71.8	50%	79.8	Surface Area (mm ²)		
30%	73.2	60%	83.5	Unwound Core	7,200	
35%	75.0	70%	87.8	40% Winding Factor	9,800	

Typical DC Bias Performance

