

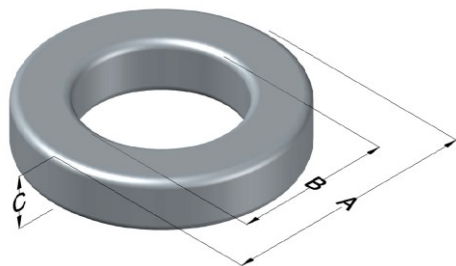

0079441A7

110 Delta Drive
 Pittsburgh, PA 15238
 NAFTA Sales: (1)800-245-3984
 HK Sales : (852)3102-9337
 magnetics@spang.com
 www.mag-inc.com



Kool Mu MAX Permeability (μ)	A_L (nH/T ²)	Core Marking			Coating Color
		Lot Number	Part Number	Inductance Grade	
14	32 ± 8%	XXXXXX	79441A7	N/A	Black

Dimensions					Packaging
Uncoated		Coated Limits			
	(mm)	(in)	(mm)	(in)	
OD (A)	46.74	1.840	47.63	1.875	max
ID (B)	24.13	0.950	23.32	0.918	min
HT (C)	18.03	0.710	18.92	0.745	max

Cardboard cut-outs
Box Qty = 105 Pcs

Electrical Characteristics			Physical Characteristics						
Watt Loss @ 50kHz, 100mT (nom, mW/cm ³)	DC Bias nom. (Oe)		Voltage Breakdown wire-to-wire min (V _{AC})	Break Strength (min, kg)	Window Area, W _A (mm ²)	Cross Section, A _e (mm ²)	Path Length, L _e (mm)	Volume V _e (mm ³)	Weight (g)
	80%	50%							
305	280	520	2000	124.7	426	199	107	21400	134.8

Winding Information					Temperature Rating	
Winding Length per Turn			Wound Coil Dimensions (mm)		Curie Temp (°C):	500 °C
Winding Factor	(mm)	Winding Factor	(mm)	40% Winding Factor	OD	51.2
0%	62.1	40%	74.1	Completely Full Window	HT	26.0
20%	68.2	45%	76.0		Max OD	63.8
25%	69.7	50%	77.6	Surface Area (mm ²)	Max HT	38.7
30%	70.9	60%	81.2		Unwound Core:	6900
35%	72.7	70%	85.4		40% Wound:	9600

Coating Temp: (Continuous, up to; °C) 200 °C

Notes:

