

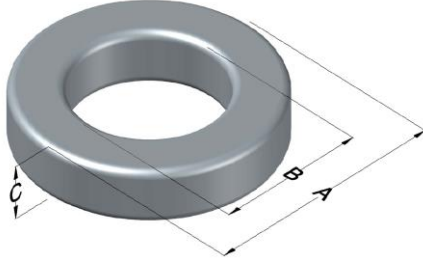

0079421A7

110 Delta Drive
 Pittsburgh, PA 15238
 NAFTA Sales: (1)800-245-3984
 HK Sales : (852)3102-9337
 magnetics@spang.com



Kool M μ MAX Permeability (μ)	A _L (nH/T ²)	Core Marking			Coating Color
		Lot Number	Part Number	Inductance Grade	
26	30 \pm 8%	XXXXXX	79421A7	N/A	Black

Dimensions	Uncoated		Coated Limits			Packaging
	(mm)	(in)	(mm)	(in)		
OD (A)	30.00	1.181	30.80	1.212	max	Cardboard cut-outs Box Qty = TBD
ID (B)	17.40	0.685	16.70	0.657	min	
HT (C)	10.90	0.429	11.80	0.464	max	

Electrical Characteristics			Physical Characteristics						
Watt Loss @ 100 kHz, 100 mT max (mW/cm ³)	DC Bias min (oersteds)		Voltage Breakdown wire to wire min (V _{AC})	Break Strength min (kg)	Window Area W _a (mm ²)	Cross Section A _e (mm ²)	Path Length L _e (mm)	Volume V _e (mm ³)	Est. Weight (g)
	80%	50%							
700	135	285	3000	TBD	219	66.5	72.7	4,840	38.7

Winding Information					Temperature Rating	
Winding Length Per Turn				Wound Coil Dimensions (mm)		Curie Temp: 500°C
Winding Factor	(mm)	Winding Factor	(mm)	40% Winding Factor		Notes:
				OD	35.3	
				HT	20.7	
				Completely Full Window		
				Max OD	35.3	
				Max HT	25.2	
0%	37.7	40%	47.0	Surface Area (mm ²)		
20%	44.7	45%	48.7	Unwound Core		2,800
25%	44.7	50%	50.1	40% Winding Factor		4,700
30%	44.7	60%	51.8			
35%	44.7	70%	55.7			

