

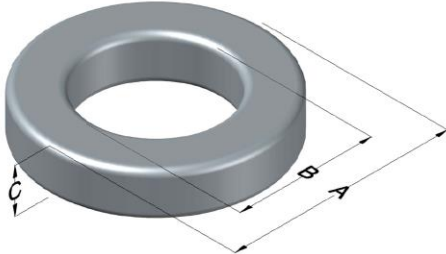

0079356A7

110 Delta Drive
 Pittsburgh, PA 15238
 NAFTA Sales: (1)800-245-3984
 HK Sales : (852)3102-9337
 magnetics@spang.com
 www.mag-inc.com



Kool M μ MAX Permeability (μ)	A _L (nH/T ²)	Core Marking			Coating Color
		Lot Number	Part Number	Inductance Grade	
40	34 ± 8%	XXXXXX	79356A7	N/A	Black

Dimensions	Uncoated		Coated Limits			Packaging
	(mm)	(in)	(mm)	(in)		
OD (A)	23.6	0.928	24.4	0.958	max	Cardboard cut-outs Box Qty= 480 pcs
ID (B)	14.4	0.567	13.7	0.542	min	
HT (C)	8.89	0.350	9.66	0.380	max	

Electrical Characteristics			Physical Characteristics						
Watt Loss @ 100 kHz, 100mT max(mW/cm ³)	DC Bias min (A-T/cm)		Voltage Breakdown wire to wire min (V _{AC})	Break Strength min (kg)	Window Area W _A (mm ²)	Cross Section A _e (mm ²)	Path Length L _e (mm)	Volume V _e (mm ³)	Weight (g)
	80%	50%							
700	65.9	143	1000	29	149	38.8	58.8	2,280	14

Winding Information					Temperature Rating	
Winding Length Per Turn				Wound Coil Dimensions (mm)		Curie Temp: 500°C
Winding Factor	(mm)	Winding Factor	(mm)	40% Winding Factor		Coating Temp (Continuous up to): 200°C
				OD	26.7	Notes:
				HT	14.2	
				Completely Full Window		Max OD
0%	29.8	40%	36.9	Max HT	21.4	
20%	33.4	45%	38.0	Surface Area (mm ²)		
25%	34.2	50%	38.9	Unwound Core		1,800
30%	35.0	60%	41.1	40% Winding Factor		2,700
35%	36.1	70%	43.6			

