

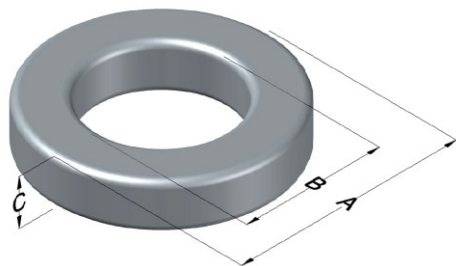

**0079190A7**

110 Delta Drive  
 Pittsburgh, PA 15238  
 NAFTA Sales: (1)800-245-3984  
 HK Sales : (852)3102-9337  
 magnetics@spang.com  
 www.mag-inc.com



Kool Mu MAX Permeability ( $\mu$ )	$A_L$ (nH/T <sup>2</sup> )	Core Marking			Coating Color
		Lot Number	Part Number	Inductance Grade	
14	32 ± 8%	XXXXXX	79190A7	N/A	Black

Dimensions					Packaging
Uncoated		Coated Limits			
	(mm)	(in)	(mm)	(in)	
OD (A)	57.15	2.250	58.04	2.285	Cardboard cut-outs Box Qty = 80 Pcs
ID (B)	26.39	1.039	25.58	1.007	
HT (C)	15.24	0.600	16.13	0.635	

Electrical Characteristics			Physical Characteristics						
Watt Loss @ 50kHz, 100mT (nom, mW/cm <sup>3</sup> )	DC Bias nom. (Oe)		Voltage Breakdown wire-to-wire min (V <sub>AC</sub> )	Break Strength (min, kg)	Window Area, W <sub>A</sub> (mm <sup>2</sup> )	Cross Section, A <sub>e</sub> (mm <sup>2</sup> )	Path Length, L <sub>e</sub> (mm)	Volume V <sub>e</sub> (mm <sup>3</sup> )	Weight (g)
	80%	50%							
305	280	520	2000	163.2	514	229	125	28600	180.2

Winding Information					Temperature Rating	
Winding Length per Turn			Wound Coil Dimensions (mm)		Curie Temp (°C):	500 °C
Winding Factor	(mm)	Winding Factor	(mm)	40% Winding Factor	OD	62.0
0%	64.6	40%	77.8	Completely Full Window	HT	24.0
20%	71.2	45%	79.8		Max OD	75.7
25%	72.9	50%	81.6	Surface Area (mm <sup>2</sup> )	Max HT	34.0
30%	74.1	60%	85.6		Unwound Core:	8500
35%	76.3	70%	90.1		40% Wound:	12000

