

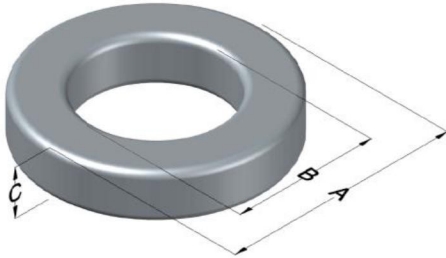

**0079169A7**

110 Delta Drive  
 Pittsburgh, PA 15238  
 NAFTA Sales: (1)800-245-3984  
 HK Sales : (852)3102-9337  
 magnetics@spang.com  
 www.mag-inc.com



Kool M $\mu$ MAX Permeability ( $\mu$ )	A <sub>L</sub> (nH/T <sup>2</sup> )	Core Marking			Coating Color
		Lot Number	Part Number	Inductance Grade	
14	42 ± 8%	XXXXXX	79169A7	N/A	Black

Dimensions	Uncoated		Coated Limits			Packaging
	(mm)	(in)	(mm)	(in)		
OD (A)	165.10	6.500	167.21	6.583	max	Cardboard cut-outs Box Qty= 8 pcs
ID (B)	88.90	3.500	86.89	3.421	min	
HT (C)	25.40	1.000	27.31	1.075	max	

Electrical Characteristics			Physical Characteristics						
Watt Loss @ 100 kHz, 100mT Max (mW/cm <sup>3</sup> )	DC Bias Min (oersteds)		Voltage Breakdown wire to wire min (V <sub>AC</sub> )	Break Strength min (kg)	Window Area W <sub>A</sub> (mm <sup>2</sup> )	Cross Section A <sub>e</sub> (mm <sup>2</sup> )	Path Length L <sub>e</sub> (mm)	Volume V <sub>e</sub> (mm <sup>3</sup> )	Weight (g)
	1200	80%							
	225	420	3000	136.0	5,930	948	386.5	366,700	2,280

Winding Information					Temperature Rating	
Winding Length Per Turn				Wound Coil Dimensions (mm)		Curie Temp: 500°C
Winding Factor	(mm)	Winding Factor	(mm)	40% Winding Factor		Coating Temp (Continuous up to): 200°C
				OD	181	
				HT	56.3	Notes:
				Completely Full Window		
				Max OD	225	
0%	135	40%	179	Max HT	103	
20%	158	45%	187	Surface Area (mm <sup>2</sup> )		
25%	163	50%	193	Unwound Core		57,000
30%	168	60%	206	40% Winding Factor		96,000
35%	175	70%	222			

