

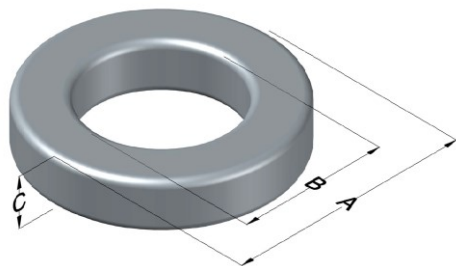

0079164A7

110 Delta Drive
 Pittsburgh, PA 15238
 NAFTA Sales: (1)800-245-3984
 HK Sales : (852)3102-9337
 magnetics@spang.com
 www.mag-inc.com



Kool Mu MAX Permeability (μ)	A_L (nH/T ²)	Core Marking			Coating Color
		Lot Number	Part Number	Inductance Grade	
14	42 ± 8%	XXXXXX	79164A7	N/A	Black

Dimensions					Packaging
Uncoated		Coated Limits			
	(mm)	(in)	(mm)	(in)	
OD (A)	165.10	6.500	166.50	6.555	Cardboard cut-outs Box Qty = 6 Pcs
ID (B)	102.41	4.032	101.02	3.977	
HT (C)	31.75	1.250	33.15	1.305	

Electrical Characteristics			Physical Characteristics						
Watt Loss @ 50kHz, 100mT (nom, mW/cm ³)	DC Bias nom. (Oe)		Voltage Breakdown wire-to-wire min (V _{AC})	Break Strength (min, kg)	Window Area, W _A (mm ²)	Cross Section, A _e (mm ²)	Path Length, L _e (mm)	Volume V _e (mm ³)	Weight (g)
	80%	50%							
305	280	520	2000	N/A	8012	987	412	407000	2564.1

Winding Information					Temperature Rating	
Winding Length per Turn			Wound Coil Dimensions (mm)		Curie Temp (°C):	500 °C
Winding Factor	(mm)	Winding Factor	(mm)	40% Winding Factor	OD	182.0
0%	131.5	40%	183.8	Completely Full Window	HT	63.2
20%	158.1	45%	191.8		Max OD	228.0
25%	164.2	50%	199.0	Surface Area (mm ²)	Max HT	103.0
30%	169.7	60%	214.8		Unwound Core:	55000
35%	177.6	70%	233.3		40% Wound:	102000

