

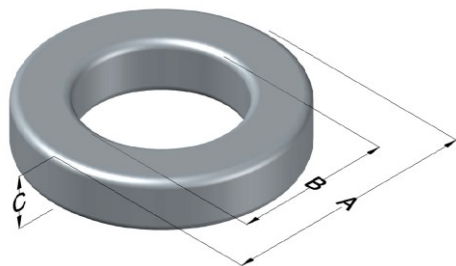

**0079101A7**

110 Delta Drive  
 Pittsburgh, PA 15238  
 NAFTA Sales: (1)800-245-3984  
 HK Sales : (852)3102-9337  
 magnetics@spang.com  
 www.mag-inc.com



Kool Mu MAX Permeability ( $\mu$ )	$A_L$ (nH/T <sup>2</sup> )	Core Marking			Coating Color
		Lot Number	Part Number	Inductance Grade	
14	26 ± 8%	XXXXXX	79101A7	N/A	Black

Dimensions					Packaging
Uncoated		Coated Limits			
	(mm)	(in)	(mm)	(in)	
OD (A)	101.60	4.000	103.00	4.055	Cardboard cut-outs Box Qty = 25 Pcs
ID (B)	57.20	2.252	55.75	2.195	
HT (C)	16.51	0.650	17.91	0.705	

Electrical Characteristics			Physical Characteristics						
Watt Loss @ 50kHz, 100mT (nom, mW/cm <sup>3</sup> )	DC Bias nom. (Oe)		Voltage Breakdown wire-to-wire min (V <sub>AC</sub> )	Break Strength (min, kg)	Window Area, W <sub>A</sub> (mm <sup>2</sup> )	Cross Section, A <sub>e</sub> (mm <sup>2</sup> )	Path Length, L <sub>e</sub> (mm)	Volume V <sub>e</sub> (mm <sup>3</sup> )	Weight (g)
	80%	50%							
305	280	520	2000	181.4	2441	358	243	87000	548.1

Winding Information					Temperature Rating	
Winding Length per Turn			Wound Coil Dimensions (mm)		Curie Temp (°C):	500 °C
Winding Factor	(mm)	Winding Factor	(mm)	40% Winding Factor	OD	112.0
0%	82.2	40%	111.2	Completely Full Window	HT	34.9
20%	96.8	45%	115.6		Max OD	136.0
25%	100.5	50%	120.0	Surface Area (mm <sup>2</sup> )	Max HT	55.1
30%	103.2	60%	128.5		Unwound Core:	20000
35%	107.9	70%	138.6		40% Wound:	36000

