

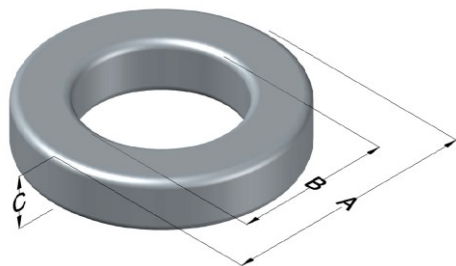

0079092A7

110 Delta Drive
 Pittsburgh, PA 15238
 NAFTA Sales: (1)800-245-3984
 HK Sales : (852)3102-9337
 magnetics@spang.com
 www.mag-inc.com



Kool M μ MAX Permeability (μ)	A_L (nH/T ²)	Core Marking			Coating Color
		Lot Number	Part Number	Inductance Grade	
14	20 \pm 8%	XXXXXX	79092A7	N/A	Black

Dimensions					Packaging
Uncoated		Coated Limits			
	(mm)	(in)	(mm)	(in)	
OD (A)	46.74	1.840	47.63	1.875	Cardboard cut-outs Box Qty = 120 Pcs
ID (B)	28.70	1.130	27.89	1.098	
HT (C)	15.24	0.600	16.13	0.635	

Electrical Characteristics			Physical Characteristics						
Watt Loss @ 50kHz, 100mT (nom, mW/cm ³)	DC Bias nom. (Oe)		Voltage Breakdown wire-to-wire min (V _{AC})	Break Strength (min, kg)	Window Area, W _A (mm ²)	Cross Section, A _e (mm ²)	Path Length, L _e (mm)	Volume V _e (mm ³)	Weight (g)
	80%	50%							
305	280	520	2000	98.8	610	134	116	15600	98.3

Winding Information					Temperature Rating	
Winding Length per Turn			Wound Coil Dimensions (mm)		Curie Temp (°C):	500 °C
Winding Factor	(mm)	Winding Factor	(mm)	40% Winding Factor	OD	52.0
0%	52.0	40%	66.4	Completely Full Window	HT	24.9
20%	59.1	45%	68.2		Max OD	66.3
25%	61.0	50%	70.4	Surface Area (mm ²)	Max HT	39.8
30%	62.2	60%	74.7		Unwound Core:	6100
35%	64.5	70%	79.5		40% Wound:	9800

