

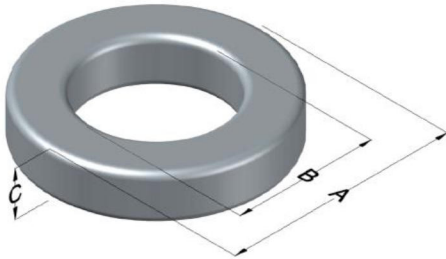

**0079076A7HT22**

110 Delta Drive  
 Pittsburgh, PA 15238  
 NAFTA Sales: (1)800-245-3984  
 HK Sales : (852)3102-9337  
 magnetics@spang.com  
 www.mag-inc.com



Kool M $\mu$ MAX Permeability ( $\mu$ )	A <sub>L</sub> (nH/T <sup>2</sup> )	Core Marking			Coating Color
		Lot Number	Part Number	Inductance Grade	
60	112 $\pm$ 8%	XXXXXX	79076A7HT22	N/A	Black

Dimensions	Uncoated		Coated Limits			Packaging
	(mm)	(in)	(mm)	(in)		
OD (A)	35.81	1.410	36.70	1.445	max	Cardboard cut-outs Box Qty= 120 pcs
ID (B)	22.35	0.880	21.54	0.848	min	
HT (C)	21.00	0.827	22.00	0.866	max	

Electrical Characteristics			Physical Characteristics						
Watt Loss @ 100 kHz, 100mT max (mW/cm <sup>3</sup> )	DC Bias max (oersteds)		Voltage Breakdown wire to wire min (V <sub>AC</sub> )	Break Strength min (kg)	Window Area W <sub>A</sub> (mm <sup>2</sup> )	Cross Section A <sub>e</sub> (mm <sup>2</sup> )	Path Length L <sub>e</sub> (mm)	Volume V <sub>e</sub> (mm <sup>3</sup> )	Weight (g)
	80%	50%							
700	58	116	3000	80	364	135.9	89.8	12,200	75

Winding Information					Temperature Rating	
Winding Length Per Turn				Wound Coil Dimensions (mm)		Curie Temp: 500°C
Winding Factor	(mm)	Winding Factor	(mm)	40% Winding Factor	OD	40.2
					HT	29.0
				Completely Full Window	Max OD	51.1
					Max HT	40.2
0%	59.2	40%	70.1	Surface Area (mm <sup>2</sup> )		
20%	64.8	45%	71.9			
25%	66.0	50%	73.6	Unwound Core		
30%	67.4	60%	76.8			
35%	68.9	70%	80.5	40% Winding Factor		
				11,700		
Coating Temp (Continuous up to): 200°C						
Notes:						

