

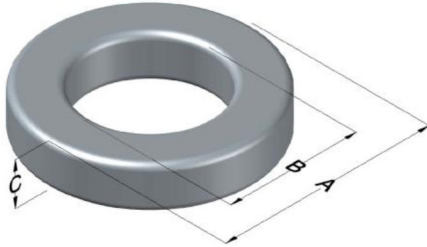

**0078872A7**

110 Delta Drive  
 Pittsburgh, PA 15238  
 NAFTA Sales: (1)800-245-3984  
 HK Sales : (852)3102-9337  
 magnetics@spang.com  
 www.mag-inc.com



XFLUX Permeability ( $\mu$ )	$A_L$ (nH/T <sup>2</sup> )	Core Marking			Coating Color
		Lot Number	Part Number	Inductance Grade	
40	45 $\pm$ 8%	XXXXXX	78872A7	N/A	Brown

Dimensions	Uncoated		Coated Limits			Packaging
	(mm)	(in)	(mm)	(in)		
OD (A)	77.80	3.063	78.94	3.108	max	Cardboard cut-outs Box Qty= 45 pcs
ID (B)	49.23	1.938	48.23	1.898	min	
HT (C)	12.70	0.500	13.84	0.545	max	

Electrical Characteristics			Physical Characteristics						
Watt Loss @ 50 kHz, 100mT max (mW/cm <sup>3</sup> )	DC Bias min (oersteds)		Voltage Breakdown wire to wire min (V <sub>AC</sub> )	Break Strength min (kg)	Window Area W <sub>A</sub> (mm <sup>2</sup> )	Cross Section A <sub>e</sub> (mm <sup>2</sup> )	Path Length L <sub>e</sub> (mm)	Volume V <sub>e</sub> (mm <sup>3</sup> )	Weight (g)
	850	80%							
	120	230							

Winding Information					Temperature Rating			
Winding Length Per Turn				Wound Coil Dimensions (mm)			Curie Temp: 700°C	
Winding Factor	(mm)	Winding Factor	(mm)	40% Winding Factor		OD	86.6	Coating Temp (Continuous up to): 200°C
				HT	29.1			
0%	58.4	40%	83.5	Completely Full Window		Max OD	112	Notes:
20%	70.9	45%	86.7	Surface Area (mm <sup>2</sup> )		Max HT	54.3	
25%	74.1	50%	90.4			Unwound Core		
30%	76.3	60%	98.1	40% Winding Factor		23,000		
35%	80.4	70%	107					

