

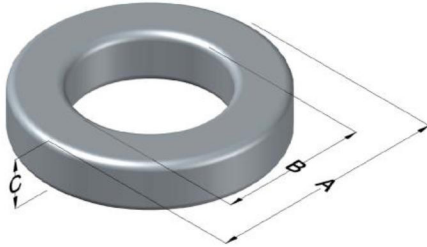

0078868A7

110 Delta Drive
 Pittsburgh, PA 15238
 NAFTA Sales: (1)800-245-3984
 HK Sales : (852)3102-9337
 magnetics@spang.com
 www.mag-inc.com



XFLUX Permeability (μ)	A_L (nH/T ²)	Core Marking			Coating Color
		Lot Number	Part Number	Inductance Grade	
26	30 ± 8%	XXXXXX	78868A7	N/A	Brown

Dimensions	Uncoated		Coated Limits			Packaging
	(mm)	(in)	(mm)	(in)		
OD (A)	77.80	3.063	78.94	3.108	max	Cardboard cut-outs Box Qty= 45 pcs
ID (B)	49.23	1.938	48.21	1.898	min	
HT (C)	12.70	0.500	13.84	0.545	max	

Electrical Characteristics			Physical Characteristics						
Watt Loss @ 50 kHz, 100mT max (mW/cm ³)	DC Bias min (oersteds)		Voltage Breakdown wire to wire min (V _{AC})	Break Strength min (kg)	Window Area W _A (mm ²)	Cross Section A _e (mm ²)	Path Length L _e (mm)	Volume V _e (mm ³)	Weight (g)
	850	80%							
	215	380							

Winding Information					Temperature Rating	
Winding Length Per Turn				Wound Coil Dimensions (mm)		Curie Temp: 700°C
Winding Factor	(mm)	Winding Factor	(mm)	40% Winding Factor		Coating Temp (Continuous up to): 200°C
				OD	86.6	
				HT	29.1	Notes:
				Completely Full Window		
				Max OD	112	
0%	58.4	40%	83.5	Max HT	54.3	
20%	70.9	45%	86.7	Surface Area (mm ²)		
25%	74.1	50%	90.4	Unwound Core		11,000
30%	76.3	60%	98.1	40% Winding Factor		23,000
35%	80.4	70%	107			

