

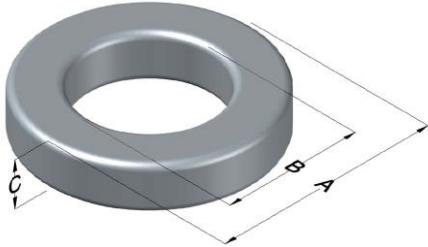

**0078739A7**

110 Delta Drive  
 Pittsburgh, PA 15238  
 NAFTA Sales: (1)800-245-3984  
 HK Sales : (852)3102-9337  
 magnetics@spang.com  
 www.mag-inc.com



XF <sub>LUX</sub> Permeability (μ)	A <sub>L</sub> (nH/T <sup>2</sup> )	Core Marking			Coating Color
		Lot Number	Part Number	Inductance Grade	
90	306 ± 8%	XXXXXX	78739A7	N/A	Brown

Dimensions	Uncoated		Coated Limits			Packaging
	(mm)	(in)	(mm)	(in)		
OD (A)	74.10	2.917	75.01	2.953	max	Cardboard cut-outs Box Qty= 24 pcs
ID (B)	45.30	1.783	44.39	1.748	min	
HT (C)	35.00	1.378	35.92	1.414	max	

Electrical Characteristics			Physical Characteristics						
Watt Loss @ 50 kHz, 100mT max (mW/cm <sup>3</sup> )	DC Bias min (oersteds)		Voltage Breakdown wire to wire min (V <sub>AC</sub> )	Break Strength min (kg)	Window Area W <sub>A</sub> (mm <sup>2</sup> )	Cross Section A <sub>e</sub> (mm <sup>2</sup> )	Path Length L <sub>e</sub> (mm)	Volume V <sub>e</sub> (mm <sup>3</sup> )	Weight (g)
	700	80%							
	48.0	95.0							

Winding Information					Temperature Rating	
Winding Length Per Turn				Wound Coil Dimensions (mm)		Curie Temp: 700°C
Winding Factor	(mm)	Winding Factor	(mm)	40% Winding Factor		Coating Temp (Continuous up to): 200°C
				OD	91.0	
				HT	55.2	Notes:
				Completely Full Window		
				Max OD	102	
0%	102	40%	125	Max HT	65.7	
20%	114	45%	129	Surface Area (mm <sup>2</sup> )		
25%	117	50%	132	Unwound Core		19,000
30%	119	60%	139	40% Winding Factor		33,000
35%	122	70%	147			

