

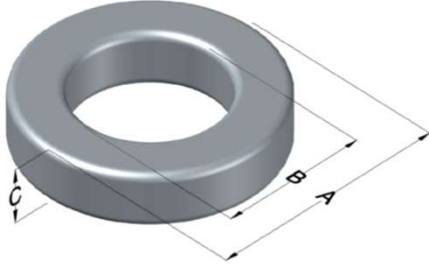

**0078534A7S01**

110 Delta Drive  
 Pittsburgh, PA 15238  
 NAFTA Sales: (1)800-245-3984  
 HK Sales : (852)3102-9337  
 magnetics@spang.com



Xflux Si Permeability ( $\mu$ )	$A_L$ (nH/T <sup>2</sup> )	Core Marking			Coating Color
		Lot Number	Part Number	Inductance Grade	
19	33 ± 8%	XXXXXX	78534A7S01	N/A	Brown

Dimensions	Uncoated		Coated Limits			Packaging
	(mm)	(in)	(mm)	(in)		
OD (A)	54.00	2.125	54.90	2.161	max	Cardboard cut-outs Box Qty= 90 pcs
ID (B)	29.00	1.141	28.10	1.106	min	
HT (C)	14.40	0.567	15.30	0.602	max	

Electrical Characteristics			Physical Characteristics						
Watt Loss @ 50kHz, 50mT max (mW/cm <sup>3</sup> )	DC Bias min (oersteds)		Voltage Breakdown wire to wire min (V <sub>AC</sub> )	Break Strength min (kg)	Window Area W <sub>a</sub> (mm <sup>2</sup> )	Cross Section A <sub>e</sub> (mm <sup>2</sup> )	Path Length L <sub>e</sub> (mm)	Volume V <sub>e</sub> (mm <sup>3</sup> )	Est. Weight (g)
	80%	50%							
225	320	600	3000	113.0	620	174	126	22,000	136

Winding Information					Temperature Rating	
Winding Length Per Turn				Wound Coil Dimensions (mm)		Curie Temp: 700°C
Winding Factor	(mm)	Winding Factor	(mm)	40% Winding Factor	OD	Coating Temp (Continuous up to): 200°C
					HT	
0%	57.4	40%	72.0	Completely Full Window	Max OD	Notes:
20%	64.7	45%	74.0		Max HT	
25%	66.5	50%	76.1	Surface Area (mm <sup>2</sup> )		
30%	67.9	60%	80.5	Unwound Core	7,500	
35%	70.2	70%	85.5	40% Winding Factor	11,000	

