

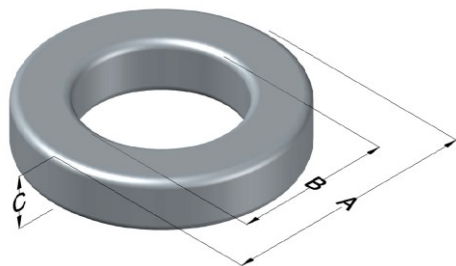

0078448A7

110 Delta Drive
 Pittsburgh, PA 15238
 NAFTA Sales: (1)800-245-3984
 HK Sales : (852)3102-9337
 magnetics@spang.com
 www.mag-inc.com



XFLUX Permeability (μ)	A_L (nH/T ²)	Core Marking			Coating Color
		Lot Number	Part Number	Inductance Grade	
26	47 ± 8%	XXXXXX	78448A7	N/A	0

Dimensions					Packaging
Uncoated		Coated Limits			
	(mm)	(in)	(mm)	(in)	
OD (A)	42.90	1.689	43.83	1.724	max
ID (B)	24.20	0.953	23.40	0.921	min
HT (C)	16.26	0.640	17.26	0.675	max

Cardboard cut-outs
Box Qty = 120 Pcs

Electrical Characteristics			Physical Characteristics						
Watt Loss @ 50kHz, 100mT (max, mW/cm ³)	DC Bias min (Oersteds)		Voltage Breakdown wire-to-wire min (V _{AC})	Break Strength (min, kg)	Window Area, W _A (mm ²)	Cross Section, A _e (mm ²)	Path Length, L _e (mm)	Volume V _e (mm ³)	Weight (g)
	80%	60%							
850	185	320	2000	98.8	430	147.5	102	15100	100.8

Winding Information					Temperature Rating	
Winding Length per Turn			Wound Coil Dimensions (mm)		Curie Temp (°C):	
Winding Factor	(mm)	Winding Factor	(mm)	40% Winding Factor	OD	700 °C
0%	55.0	40%	67.1	Completely Full Window	48.4	Coating Temp: 200 °C (Continuous, up to; °C)
20%	61.1	45%	68.9		HT	
25%	62.5	50%	70.8	Surface Area (mm ²)	Max OD	Notes:
30%	63.8	60%	74.2		Max HT	
35%	65.6	70%	78.5	Unwound Core:	5800	
				40% Wound:	8400	

